

DARGLOBAL



THE
WEEKEND

FROM LES VAGUES BY ELIE SAAB



DISRUPT
THE DAY



SEEK
OUT THE
UNFAMILIAR

GIVE IN
TO YOUR
DESIRES

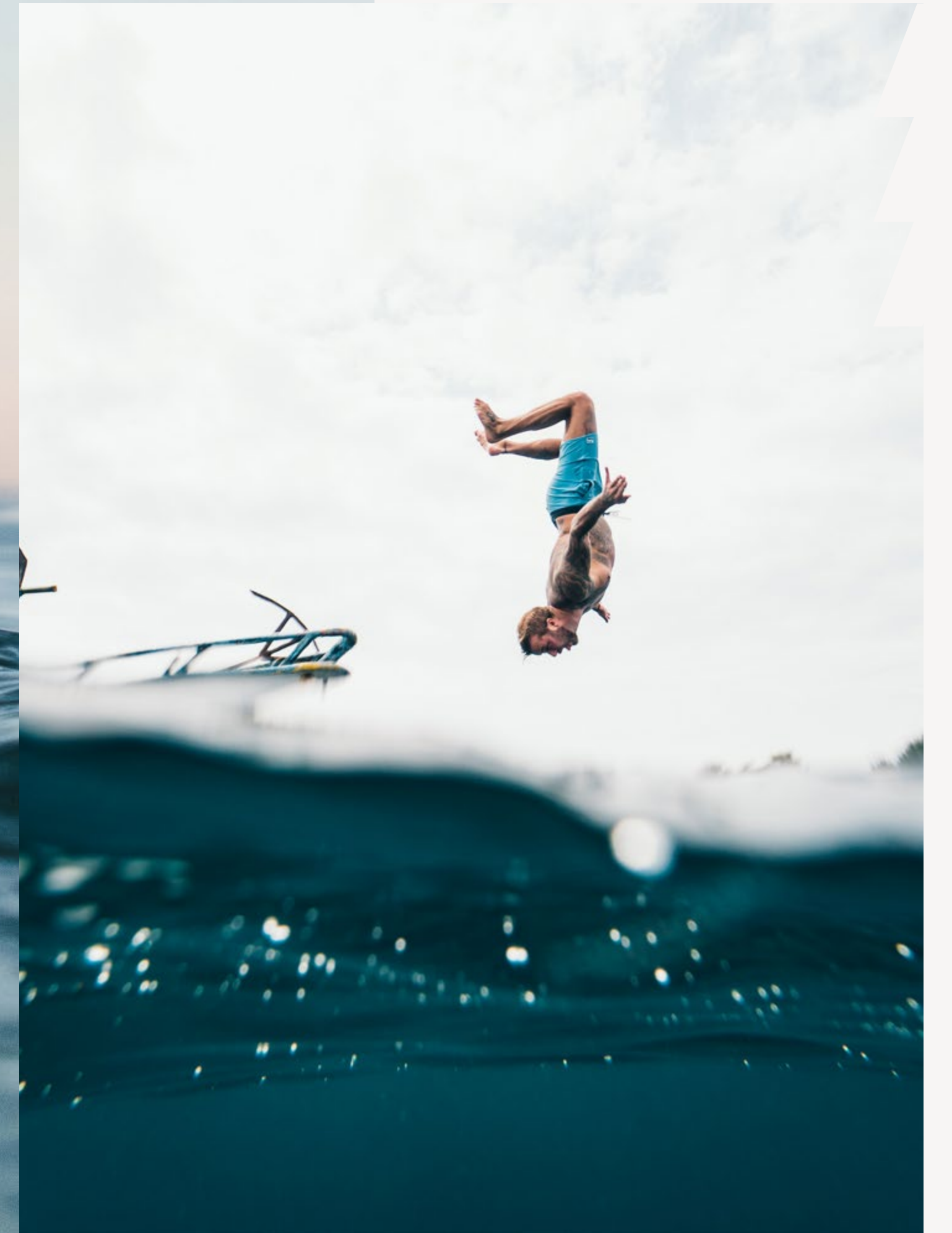

LEAVE
YOUR
INHIBITIONS
BEHIND



DARGLOBAL | ELIE SAAB

THE WEEKEND

FROM LES VAGUES BY ELIE SAAB



GOLDEN SUNSETS,
MIDNIGHT DIPS AND
FINE DINING AWAIT YOU
AT THE WEEKEND BY
ELIE SAAB

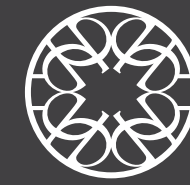

ELIE SAAB

LEGACY LIVING

At just the tender age of 18, ELIE SAAB founded his eponymous label in 1982. Since then, the ELIE SAAB house has been established as one of the major leaders in the HAUTE COUTURE category globally, with ateliers based in Paris, London and Beirut. ELIE SAAB has continued to build on the inherent savoir-faire and innate elegance for which it is renowned, expanding into the ready-to-wear, bridal, accessories, eyewear, kids wear and the fragrance categories.

Along with the brand's venture into home and interiors, with the MAISON line, ELIE SAAB joins the premiere league of the world's global luxury fashion and lifestyle brands.



DARGLOBAL | ELIE SAAB

LUXURY GETAWAYS START HERE

Situated in Qetaifan Island North, a place of unimaginable beauty, The Weekend is paradise on earth for getaway couture living. Enjoy exclusive residences nestled alongside luxurious beach resorts, private beaches, clubhouses, world-class boating facilities, boutique shopping experiences, a water park, and a living garden.

A LANDMARK DESTINATION

QETAIFAN ISLAND NORTH



QETAIFAN ISLAND NORTH

Situated in Qetaifan Island North, a place of unimaginable beauty, The Weekend is paradise on earth for getaway couture living. Enjoy exclusive residences nestled alongside luxurious beach resorts, private beaches, clubhouses, world-class boating facilities, boutique shopping experiences, a water park, and a living garden.

A PARADISE ON EARTH

Qetaifan Island North is 1.3 million square metres of picturesque luxuriousness that, much like ELIE SAAB's creations, is destined to become internationally recognized, a landmark location and a symbol of Qatar's burgeoning future. The main artery of the island, linking all zones together is the Linear Park. An artificial Salt Lake that flows to the sea, where you can fish, you can boat, you can vacation an unrivalled island experience.



THE WEEKEND

LUSAIL

THE PEARL-QATAR

DOHA



THE
WEEKEND
YOU
ALWAYS
DREAMT OF





DESTINED *TO BECOME* THE *NEXT* VACATION SPOT

The building gently rises out of the sands with clean and contemporary lines, which are softened by carefully selected palms and tropical foliage.

The weekend is an ode to weekend island life, exclusively featuring 2-bedroom sea-front residences with majestic terraces.



WHERE *MEMORIES* ARE MEANT *TO BE MADE*

The residences are right at the shoreline, with floor to ceiling windows you can enjoy the ocean vista flood in from all sides, leaving even the most hardened of visitors speechless.





LIVING IN
THE LEGACY
OF *ELIE SAAB*

THE INTERIORS ARE A LEGACY OF ELIE SAAB. THE OBSESSIVE ATTENTION TO DETAIL. EXPERT CRAFTSMANSHIP AND FLAWLESS DESIGN IS WHAT SEPARATES THE WEEKEND FROM THE REST.



Enjoy interiors of soft creams and legacy tones, bespoke surfaces and plush creations, each carefully woven to iconize memories.



AMENITIES MADE TO EXTEND VACATIONS

 State of the art fitness center

 Infinity swimming pool

 Landscaped community courtyard with sea views

 A la carte concierge services

 4 Passenger elevators, inclusive of a service elevator to all floors

 Luxury retail

 24hrs reception desk

 Public areas furniture designed and selected by ELIE SAAB

 Parking for all units



MUCH LIKE THE
BESPOKE CREATIONS
OF ELIE SAAAB, THE
AMENITIES ARE
TAILORED TO YOUR
WEEKEND NEEDS.



LES VAGUES
by
ELIE SAAB





SHORT LUXURY
GETAWAY
HIGH RETURN
ON INVESTMENT



THE WEEKEND IS
MADE UP EXCLUSIVELY
OF TWO-BEDROOM
RESIDENCES WITH
FEATURES THAT
OFFER A ONCE
IN A LIFETIME
OPPORTUNITY TO
INVEST IN.

Not only are they part of the first
cobranded residential project in
Qatar, but also, The Weekend features
interiors by Elie Saab, panoramic
views of the Doha skyline and
easy access to the shores, cultural
destinations and recreational facilities
of Qetaifan Island North.

10 REASONS TO INVEST IN THE WEEKEND

- 01 / *FREEHOLD PROPERTY*
- 02 / *0% PROPERTY TAX*
- 03 / *1% REGISTRATION FEES*
- 04 / *100% FOREIGN OWNERSHIP*
- 05 / *GOLDEN VISA*
- 06 / *THE FIRST COBRANDED
RESIDENTIAL PROJECT IN QATAR*
- 07 / *SITUATED IN QETAIFAN ISLAND NORTH*
- 08 / *INTERIORS BY ELIE SAAB*
- 09 / *ONLY 30 MINUTES AWAY FROM
HAMAD INTERNATIONAL AIRPORT*
- 10 / *EASY ACCESS TO DOHA'S LANDMARKS*



DARGLOBAL | ELIE SAAB

THE WEEKEND

FLOOR PLANS

The following floor plans are only applicable to Building D. All pictures, plans, layouts, information, data and details included in this brochure are indicative only and may change at any time up to the final 'as built' status in accordance with final designs of the project, regulatory approvals and planning permissions. All accessories and interior finishes such as wallpaper, chandeliers, furniture, electronics, white goods, curtains, hard and soft landscaping, pavements, features, gym, swimming pool(s) and other elements displayed in the brochure, or within the show apartment or between the plot boundary and the unit, are not part of the unit and are shown for illustrative purposes only.

THE WEEKEND
FROM LES VAGUES BY ELIE SAAB

2-BED Type A	FLOORS	
	G, 1 - 5	
RESIDENCE	83.62 - 83.81 sqm	900.08 - 902.12 sqft
BALCONY / TERRACE	18.59 - 111.9 sqm	200.1 - 1204.48 sqft
TOTAL	102.23 - 195.71 sqm	1100.39 - 2106.6 sqft

MASTERPLAN

The following floor plans are only applicable to Building D. All pictures, plans, layouts, information, data and details included in this brochure are indicative only and may change at any time up to the final 'as built' status in accordance with final designs of the project, regulatory approvals and planning permissions. All accessories and interior finishes such as wallpaper, chandeliers, furniture, electronics, white goods, curtains, hard and soft landscaping, pavements, features, gym, swimming pool(s) and other elements displayed in the brochure, or within the show apartment or between the plot boundary and the unit, are not part of the unit and are shown for illustrative purposes only.

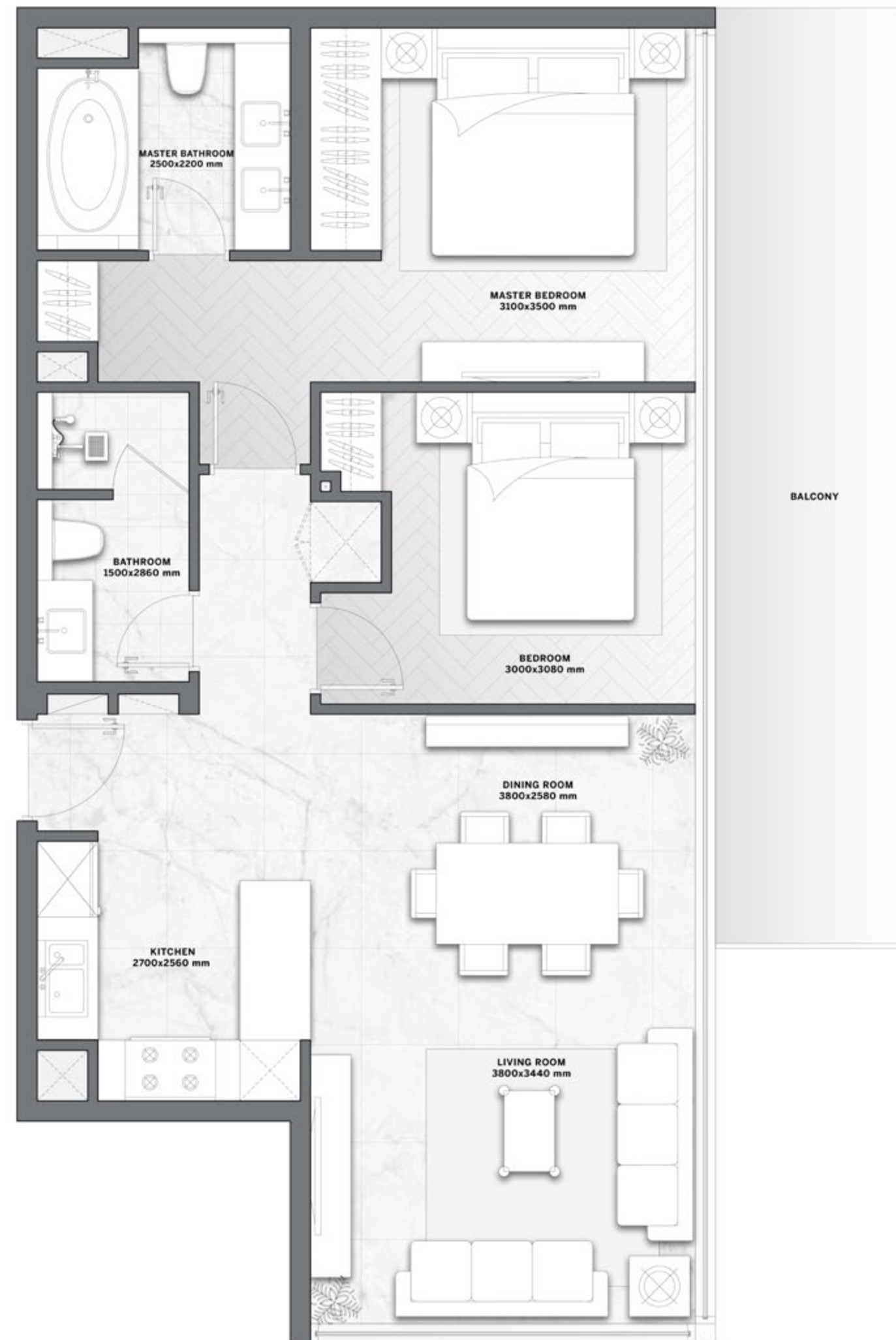

THE WEEKEND

FROM LES VAGUES BY ELIE SAAB

BUILDING D - KEY PLANS	
2-BED	
Type A	
FLOORS	
G, 1 - 5	

FLOOR G

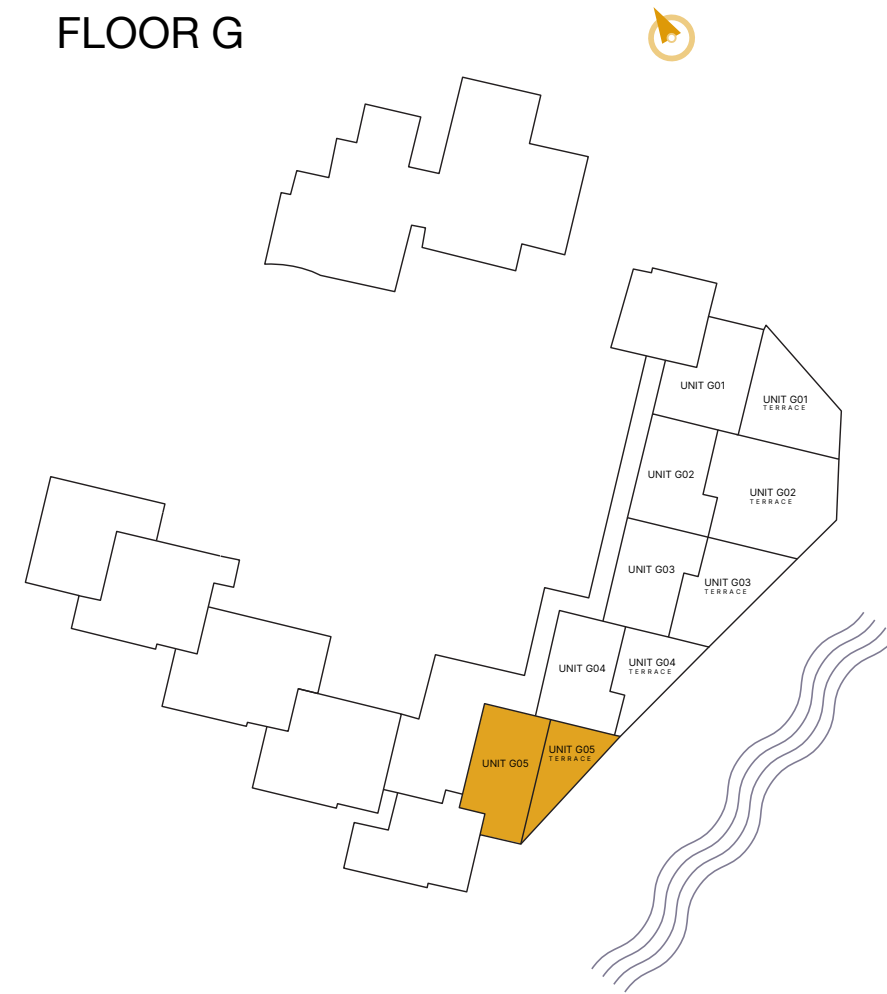

FLOOR 1

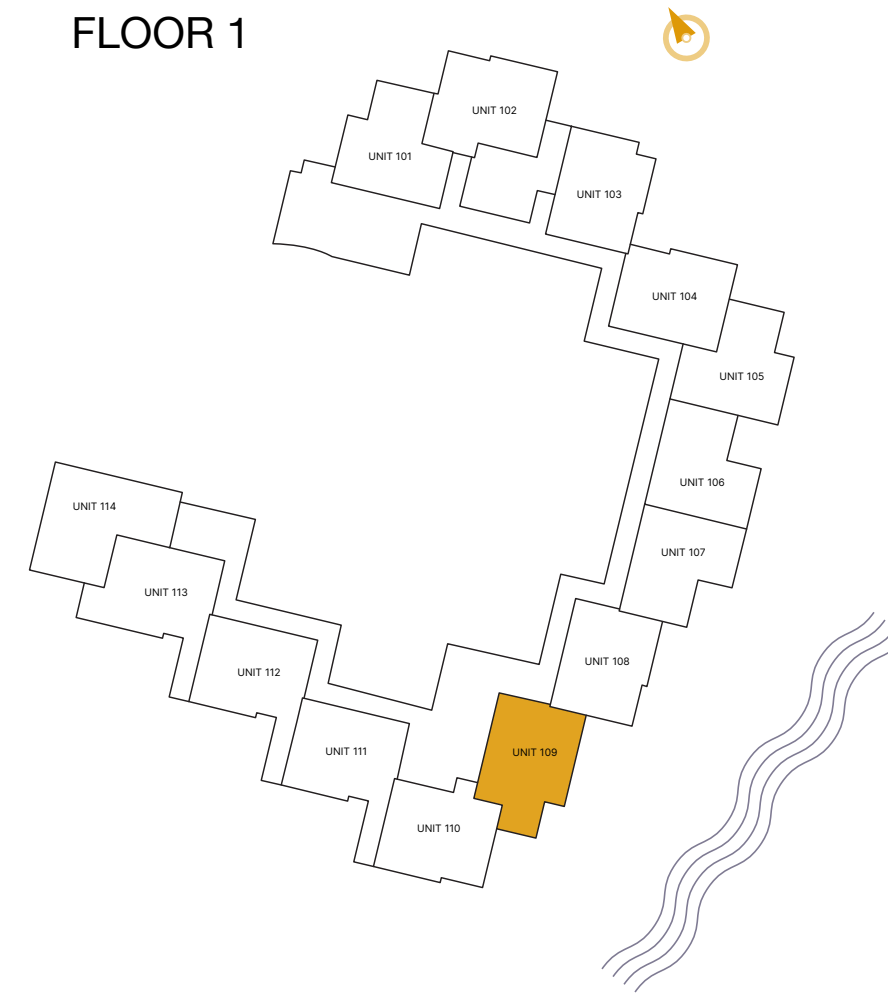

FLOOR 2



FLOOR 3

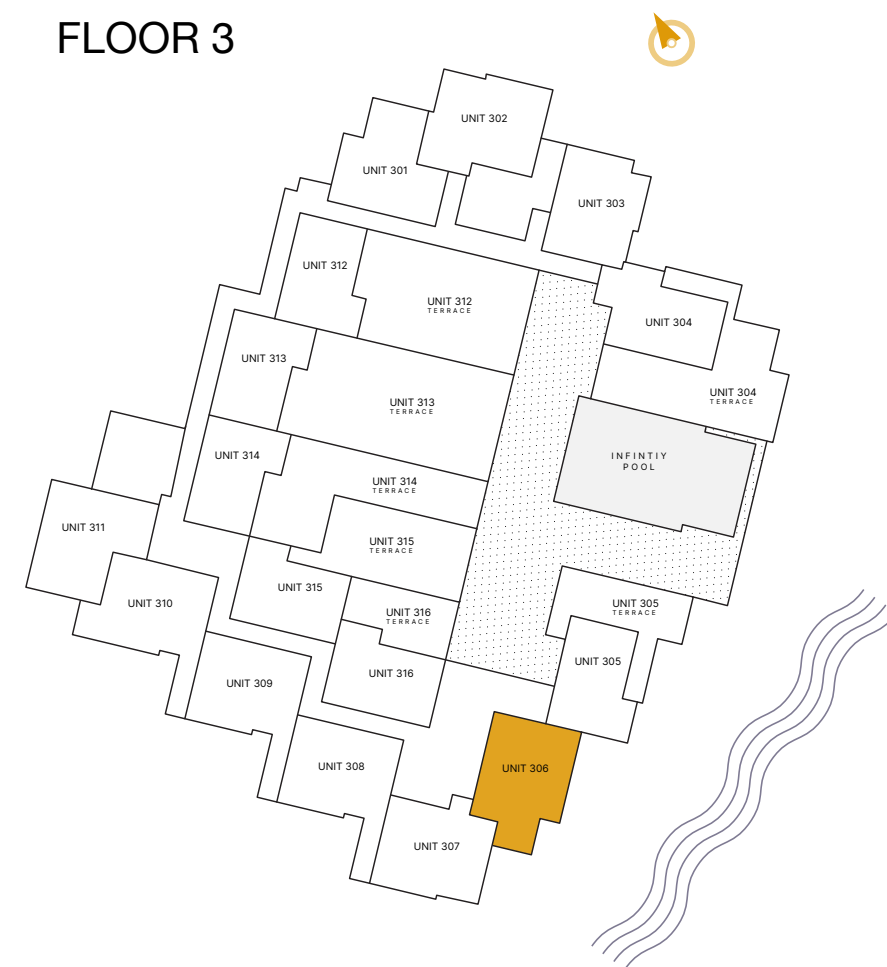

FLOOR 4

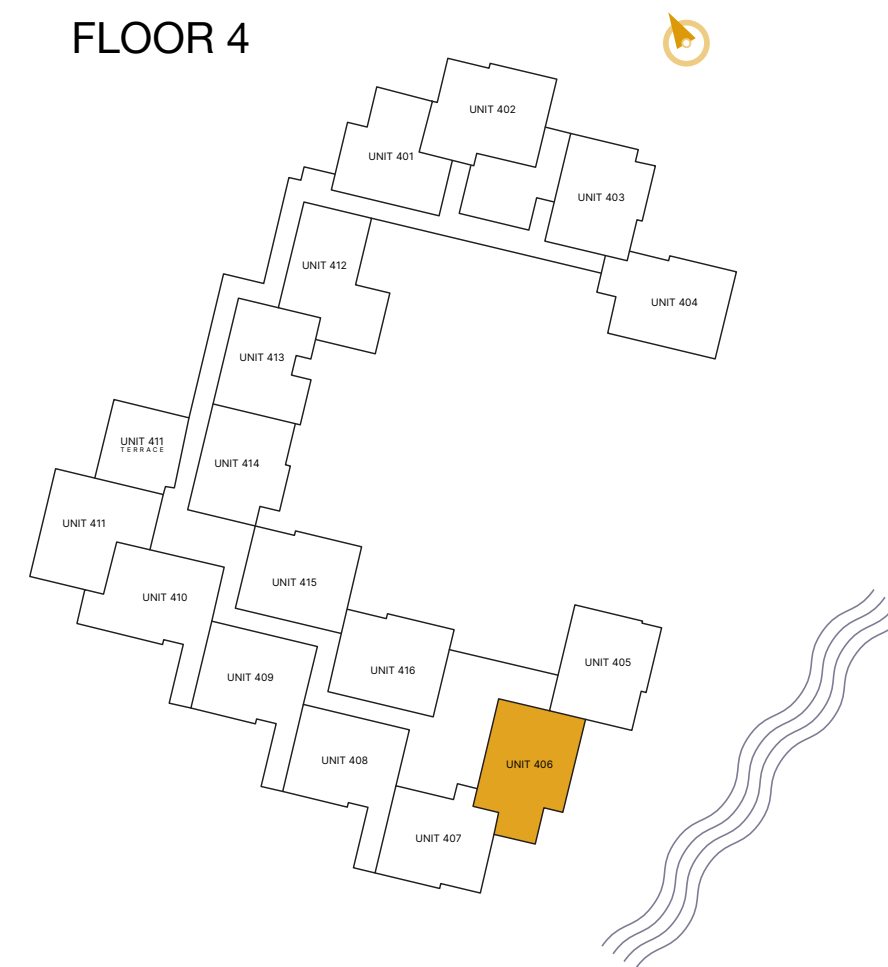

FLOOR 5

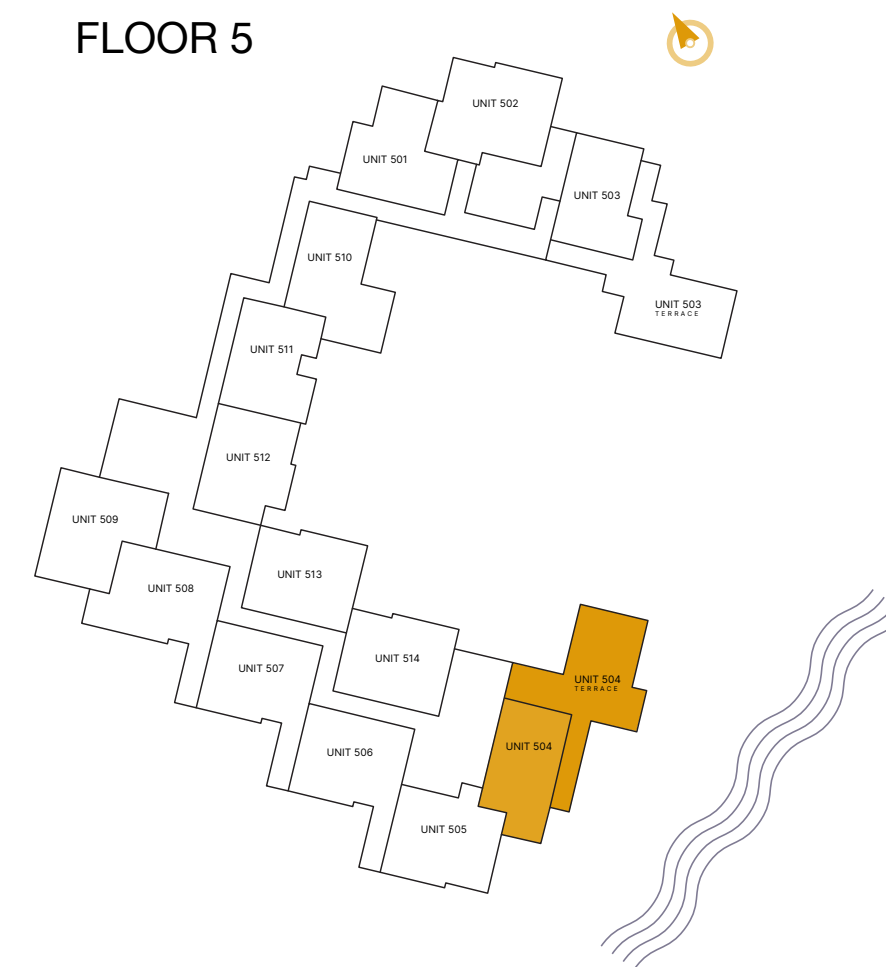

THE WEEKEND
FROM LES VAGUES BY ELIE SAAB

2-BED Type B	FLOORS	
	G, 1 - 5	
RESIDENCE	79.99 - 81.09 sqm	861.01 - 872.85 sqft
BALCONY / TERRACE	15.2 - 226.57 sqm	163.61 - 2438.78 sqft
TOTAL	95.19 - 306.97 sqm	1024.62 - 3304.2 sqft

MASTERPLAN

The following floor plans are only applicable to Building D. All pictures, plans, layouts, information, data and details included in this brochure are indicative only and may change at any time up to the final 'as built' status in accordance with final designs of the project, regulatory approvals and planning permissions. All accessories and interior finishes such as wallpaper, chandeliers, furniture, electronics, white goods, curtains, hard and soft landscaping, pavements, features, gym, swimming pool(s) and other elements displayed in the brochure, or within the show apartment or between the plot boundary and the unit, are not part of the unit and are shown for illustrative purposes only.



THE WEEKEND

FROM LES VAGUES BY ELIE SAAB

BUILDING D - KEY PLANS
2-BED Type B
FLOORS
G, 1 - 5

FLOOR G

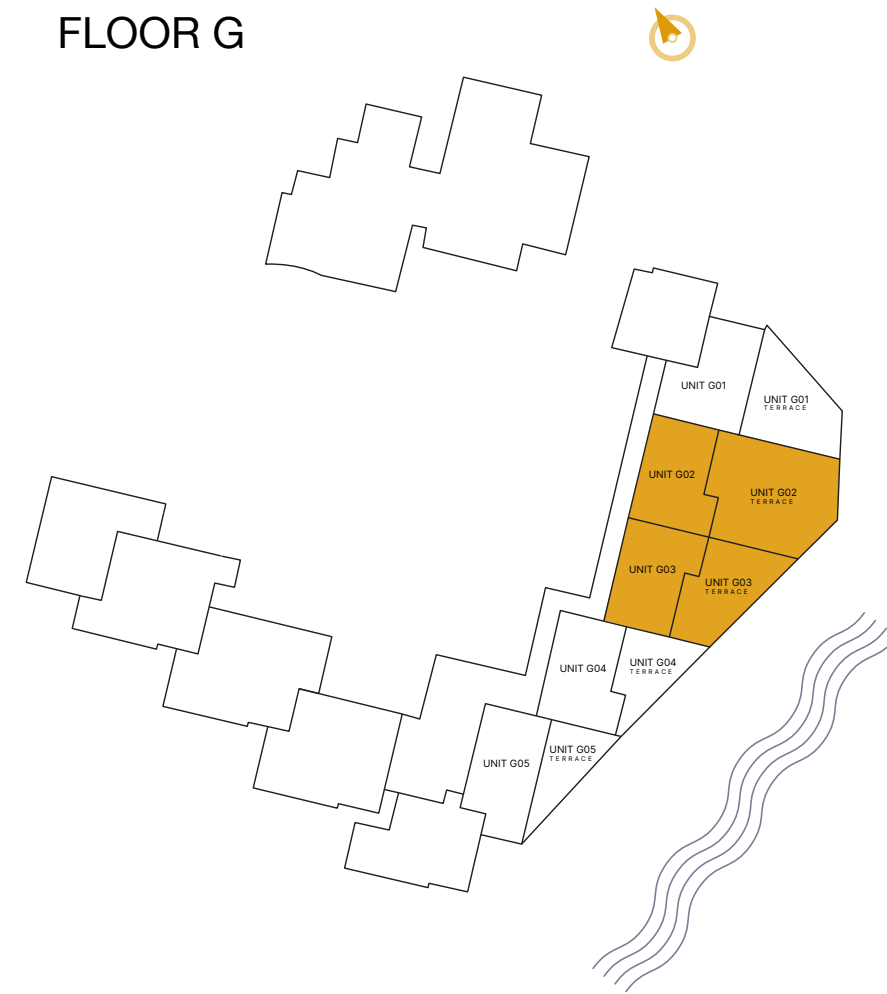

FLOOR 1

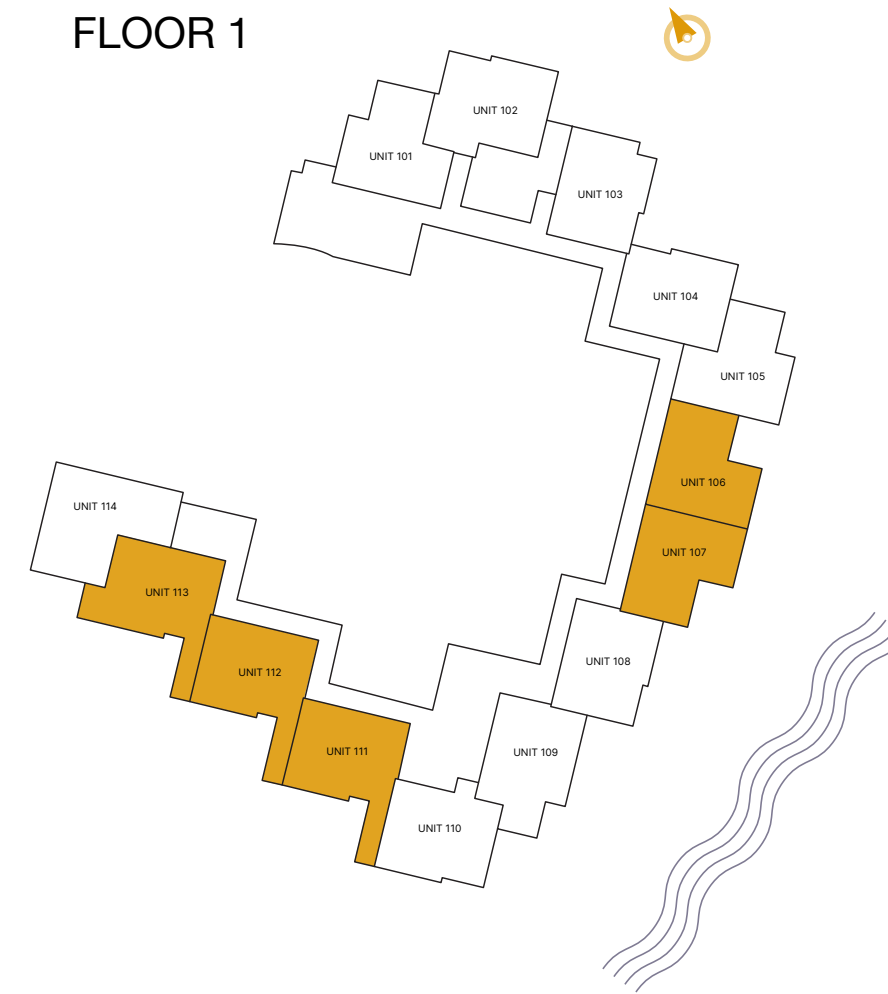

FLOOR 2



FLOOR 3



FLOOR 4

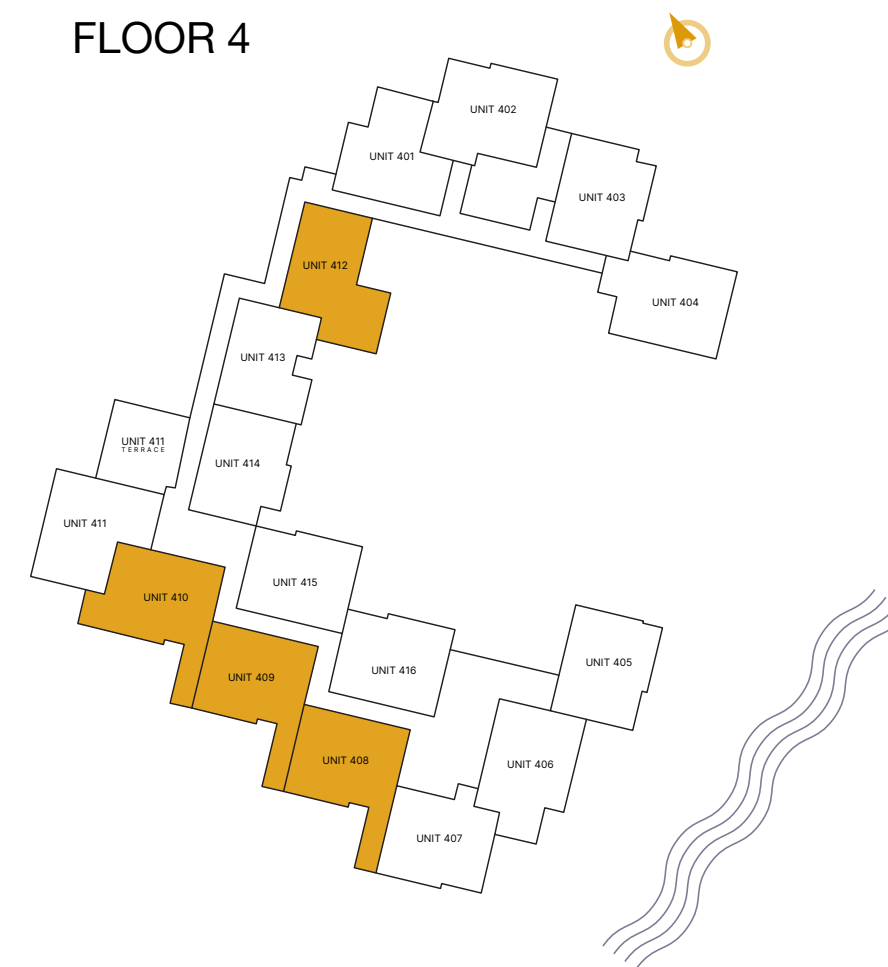

FLOOR 5

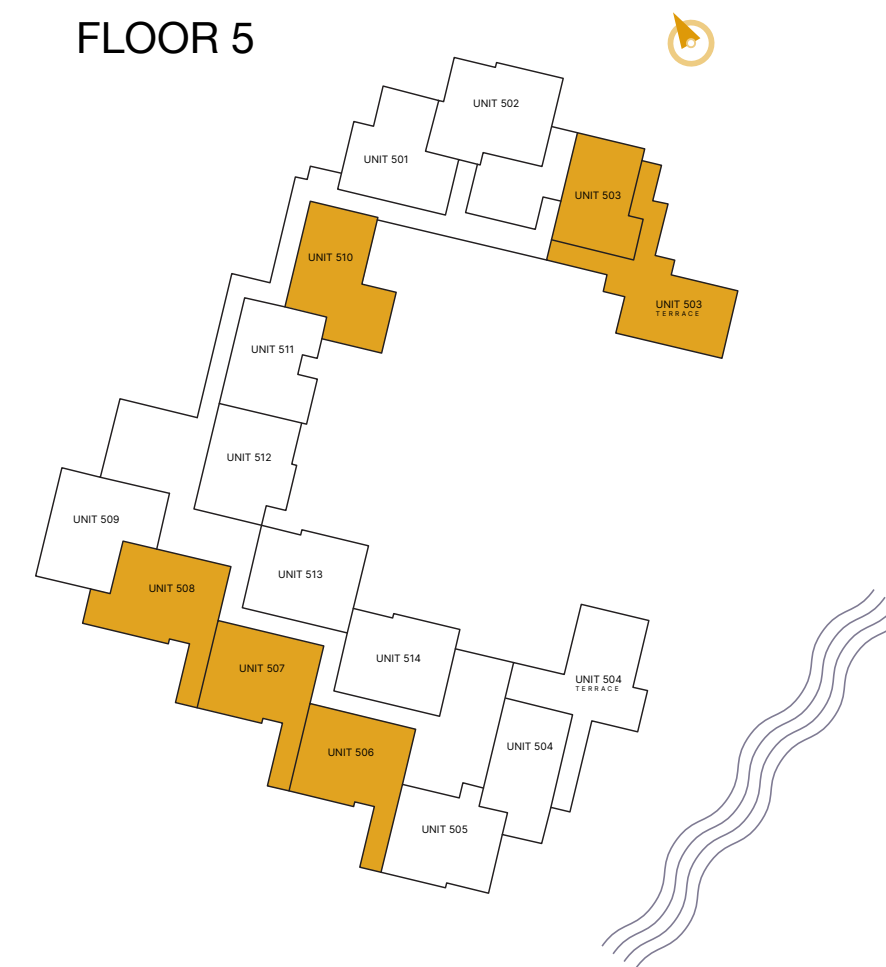

THE WEEKEND
FROM LES VAGUES BY ELIE SAAB

2-BED Type B1		FLOORS
		3 - 4
RESIDENCE	89.07 sqm	958.74 sqft
BALCONY / TERRACE	13.60 - 134.02 sqm	146.39 - 1442.58 sqft
TOTAL	102.67 - 238.69 sqm	1105.13 - 2569.24 sqft

MASTERPLAN

The following floor plans are only applicable to Building D. All pictures, plans, layouts, information, data and details included in this brochure are indicative only and may change at any time up to the final 'as built' status in accordance with final designs of the project, regulatory approvals and planning permissions. All accessories and interior finishes such as wallpaper, chandeliers, furniture, electronics, white goods, curtains, hard and soft landscaping, pavements, features, gym, swimming pool(s) and other elements displayed in the brochure, or within the show apartment or between the plot boundary and the unit, are not part of the unit and are shown for illustrative purposes only.

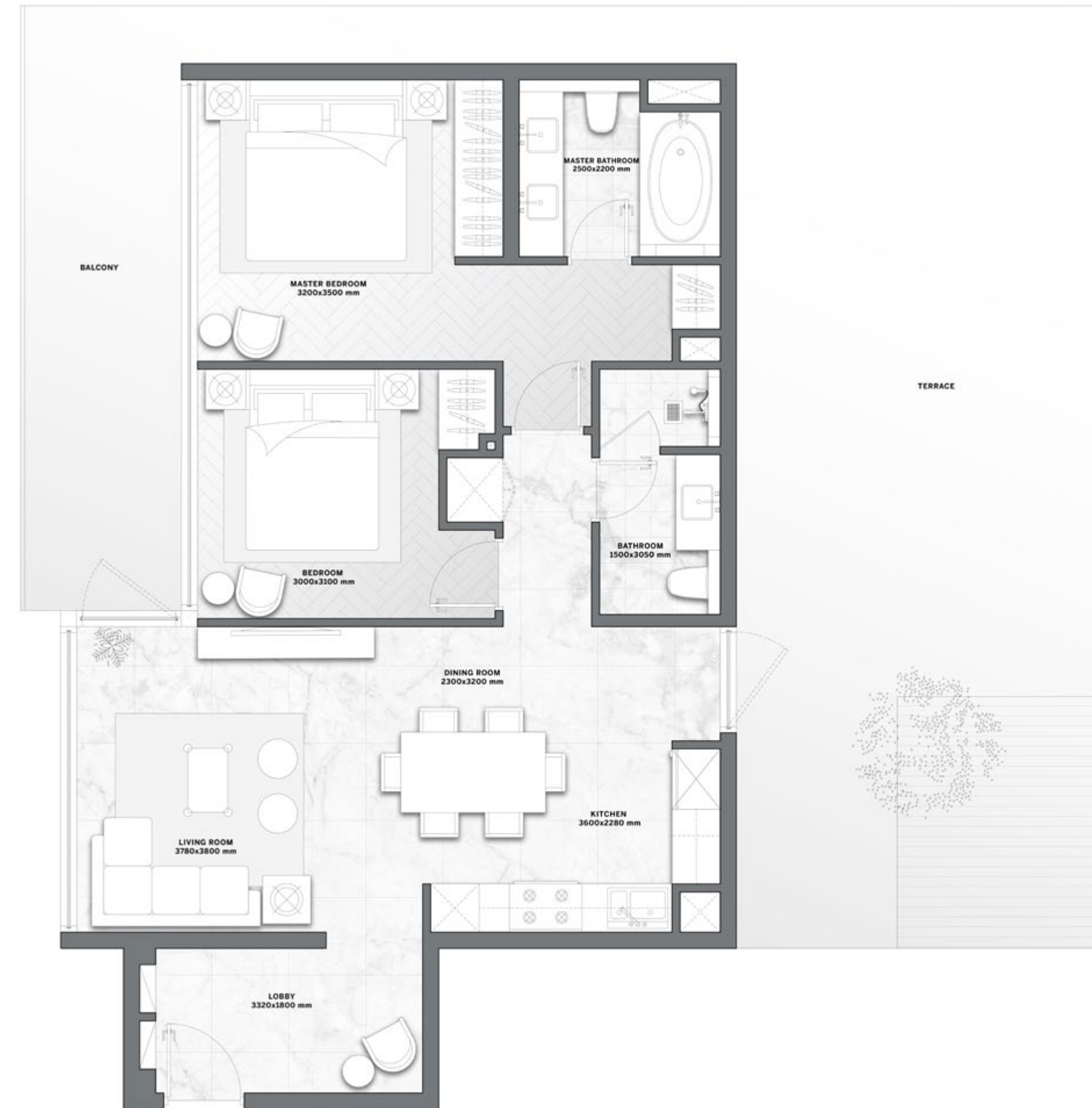

THE WEEKEND
FROM LES VAGUES BY ELIE SAAB

BUILDING D - KEY PLANS
2-BED Type B1
FLOORS
3 - 4

FLOOR 3

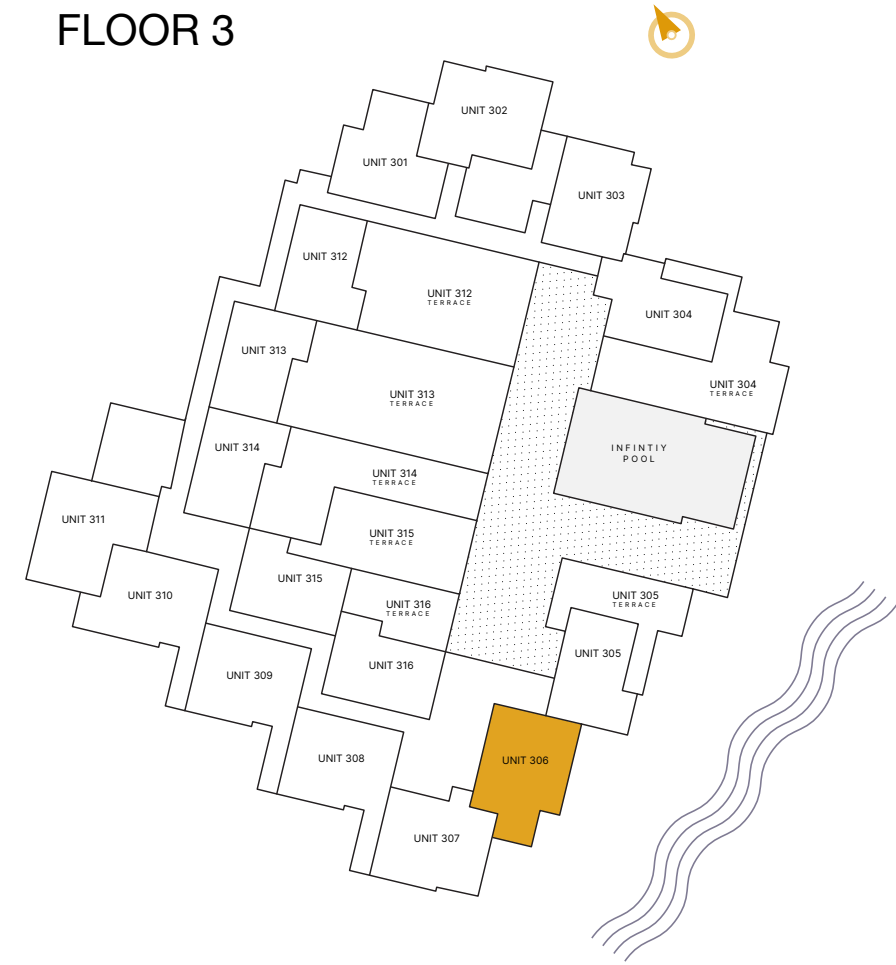

FLOOR 4

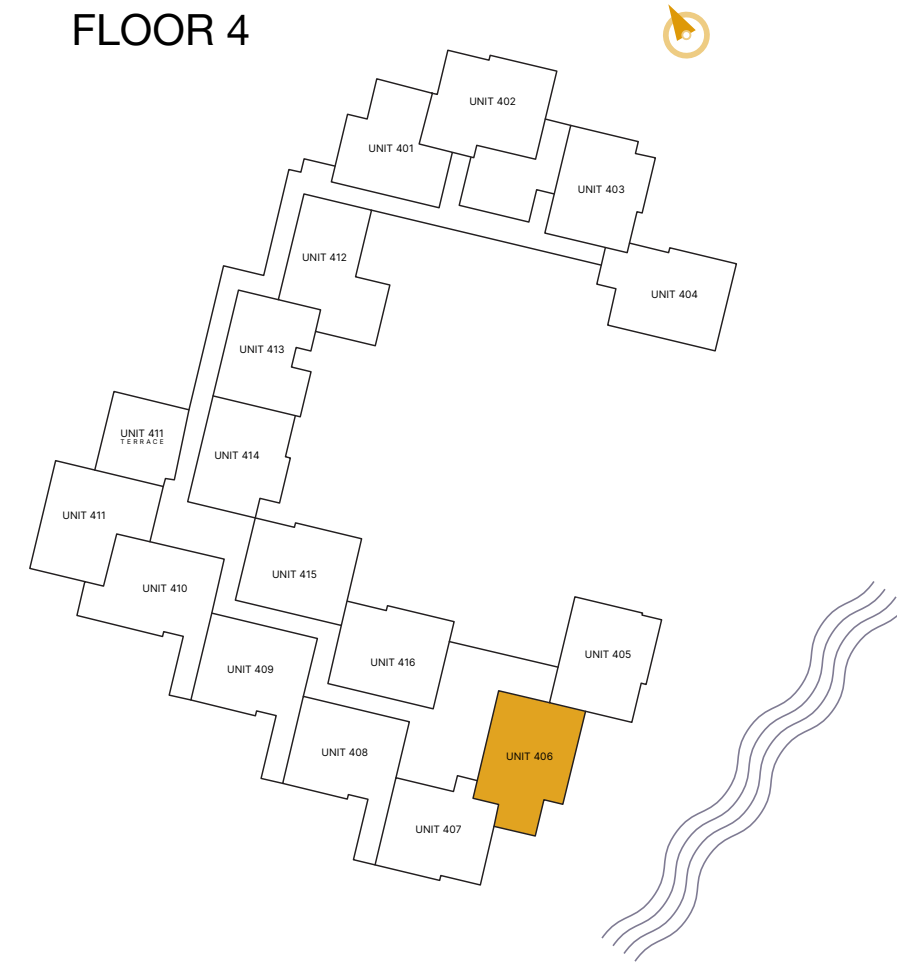

THE WEEKEND
FROM LES VAGUES BY ELIE SAAB

2-BED Type B2	FLOORS	
	1 - 5	
RESIDENCE	83.67 - 83.84 sqm	900.62 - 902.45 sqft
BALCONY / TERRACE	13.38 - 13.40 sqm	144.02 - 144.24 sqft
TOTAL	97.07 - 97.22 sqm	1044.85 - 1046.47 sqft

MASTERPLAN

The following floor plans are only applicable to Building D. All pictures, plans, layouts, information, data and details included in this brochure are indicative only and may change at any time up to the final 'as built' status in accordance with final designs of the project, regulatory approvals and planning permissions. All accessories and interior finishes such as wallpaper, chandeliers, furniture, electronics, white goods, curtains, hard and soft landscaping, pavements, features, gym, swimming pool(s) and other elements displayed in the brochure, or within the show apartment or between the plot boundary and the unit, are not part of the unit and are shown for illustrative purposes only.



THE WEEKEND

FROM LES VAGUES BY ELIE SAAB

BUILDING D - KEY PLANS
2-BED Type B2
FLOORS 1 - 5

FLOOR 1

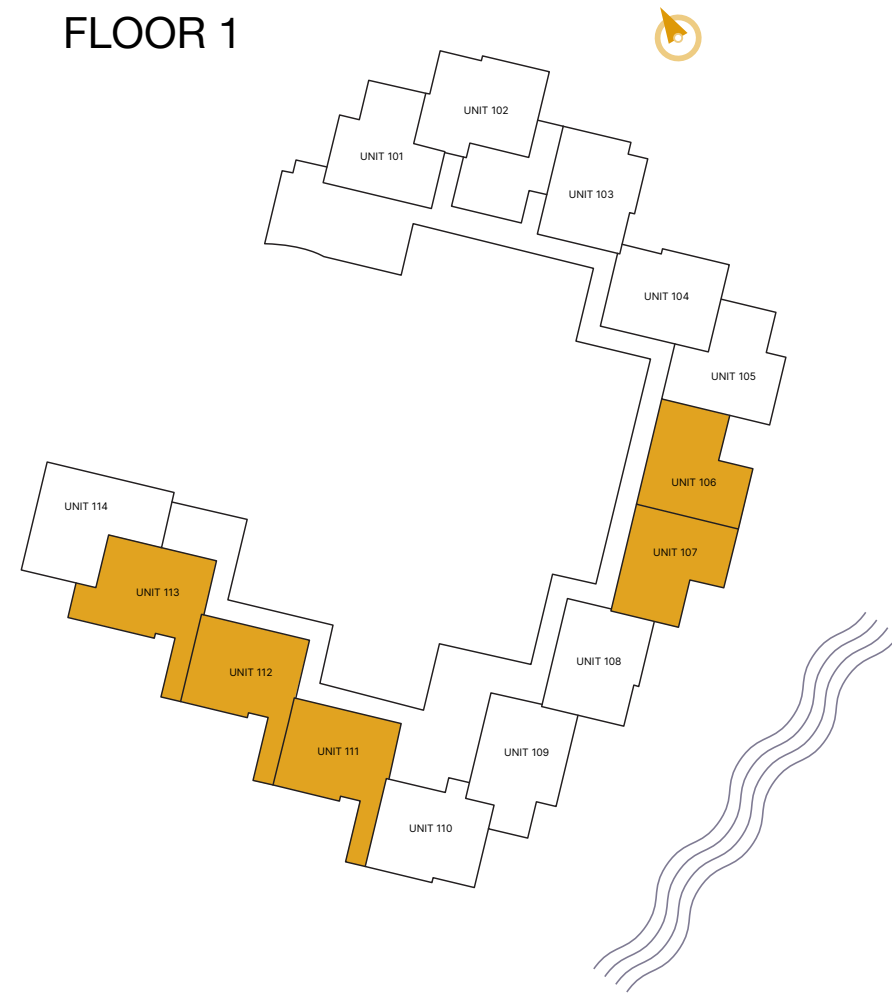

FLOOR 2

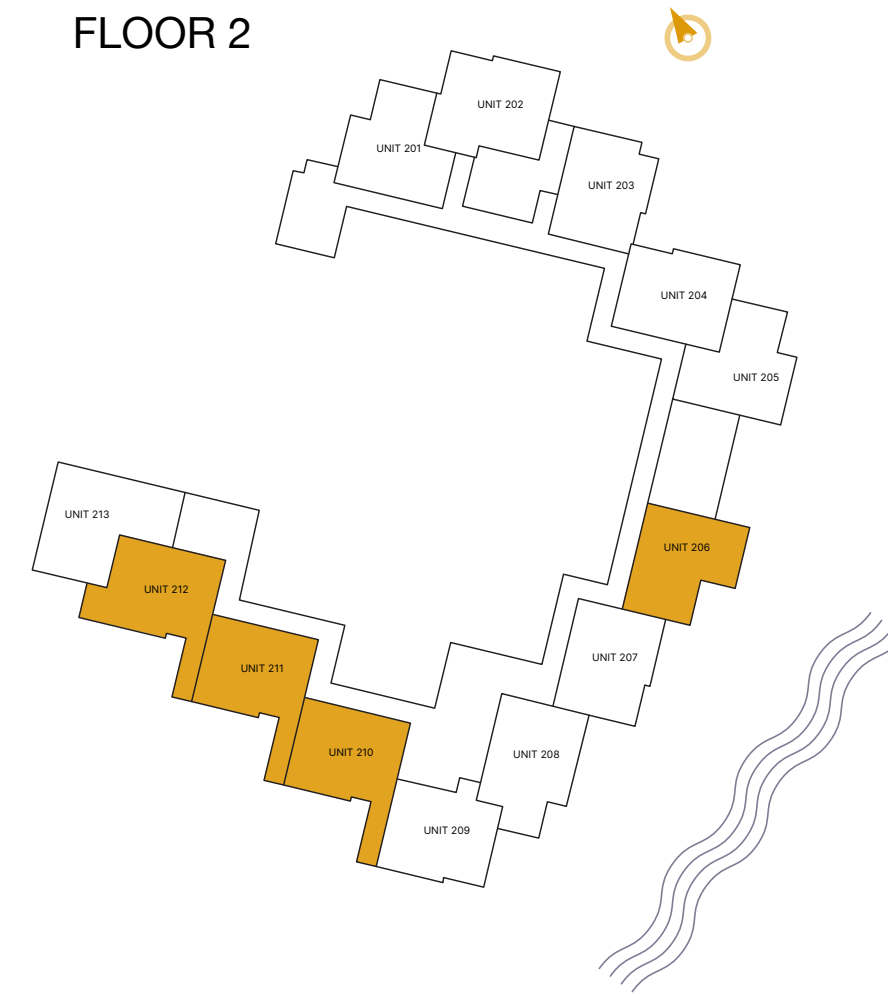

FLOOR 3



FLOOR 4



FLOOR 5

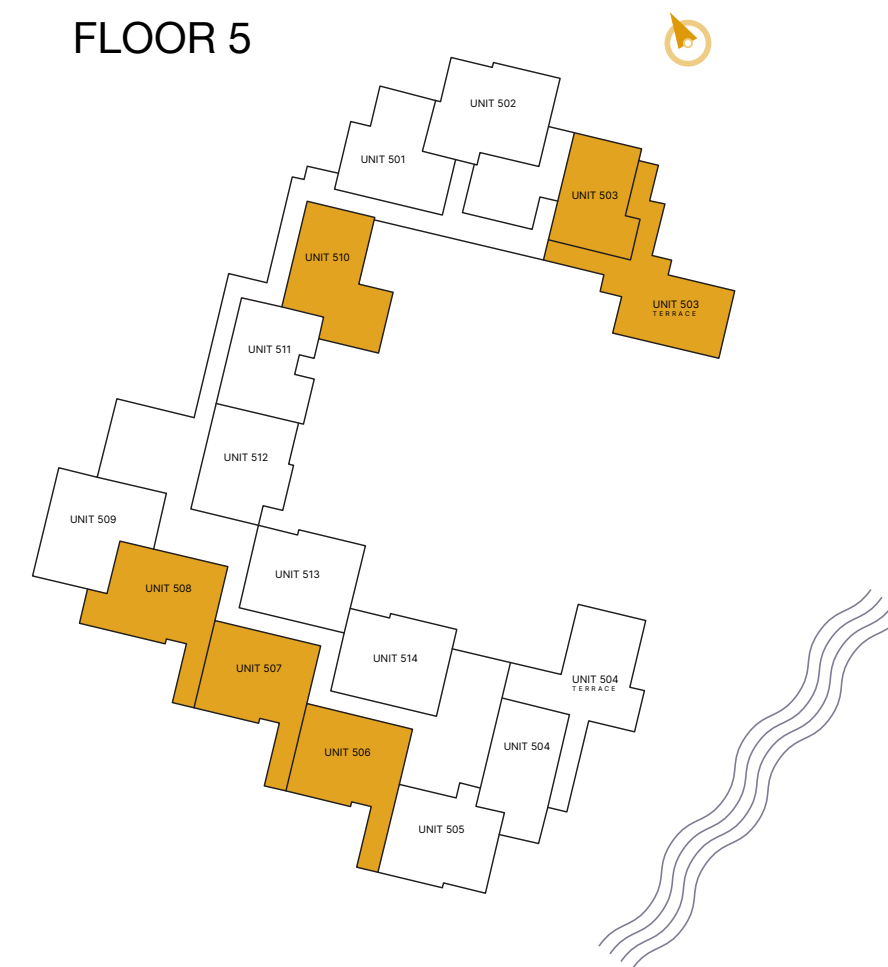

THE WEEKEND
FROM LES VAGUES BY ELIE SAAB

2-BED Type B3		FLOORS
		1 - 5
RESIDENCE	87.63 - 87.69 sqm	943.24 - 943.89 sqft
BALCONY / TERRACE	13.59 - 13.64 sqm	146.28 - 146.82 sqft
TOTAL	101.27 - 101.29 sqm	1090.06 - 1090.28 sqft

MASTERPLAN

The following floor plans are only applicable to Building D. All pictures, plans, layouts, information, data and details included in this brochure are indicative only and may change at any time up to the final 'as built' status in accordance with final designs of the project, regulatory approvals and planning permissions. All accessories and interior finishes such as wallpaper, chandeliers, furniture, electronics, white goods, curtains, hard and soft landscaping, pavements, features, gym, swimming pool(s) and other elements displayed in the brochure, or within the show apartment or between the plot boundary and the unit, are not part of the unit and are shown for illustrative purposes only.



THE WEEKEND
FROM LES VAGUES BY ELIE SAAB

BUILDING D - KEY PLANS
2-BED Type B3
FLOORS
1 - 5

FLOOR 1

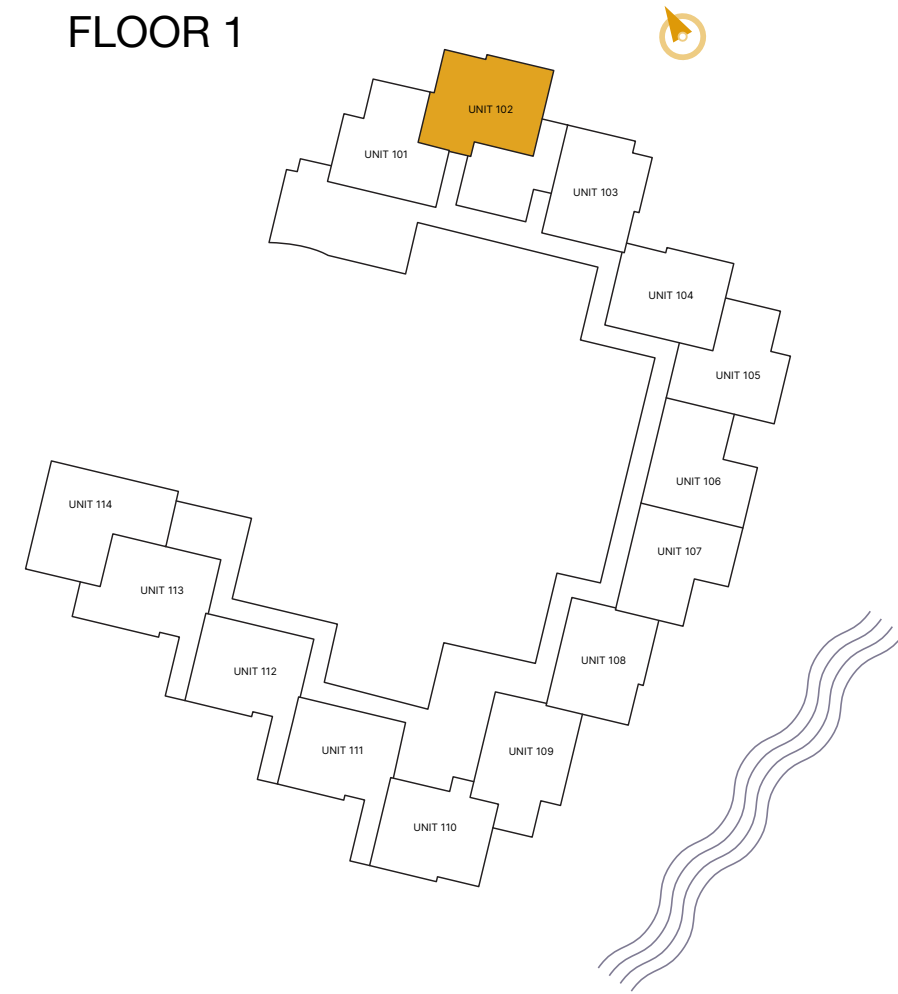

FLOOR 2

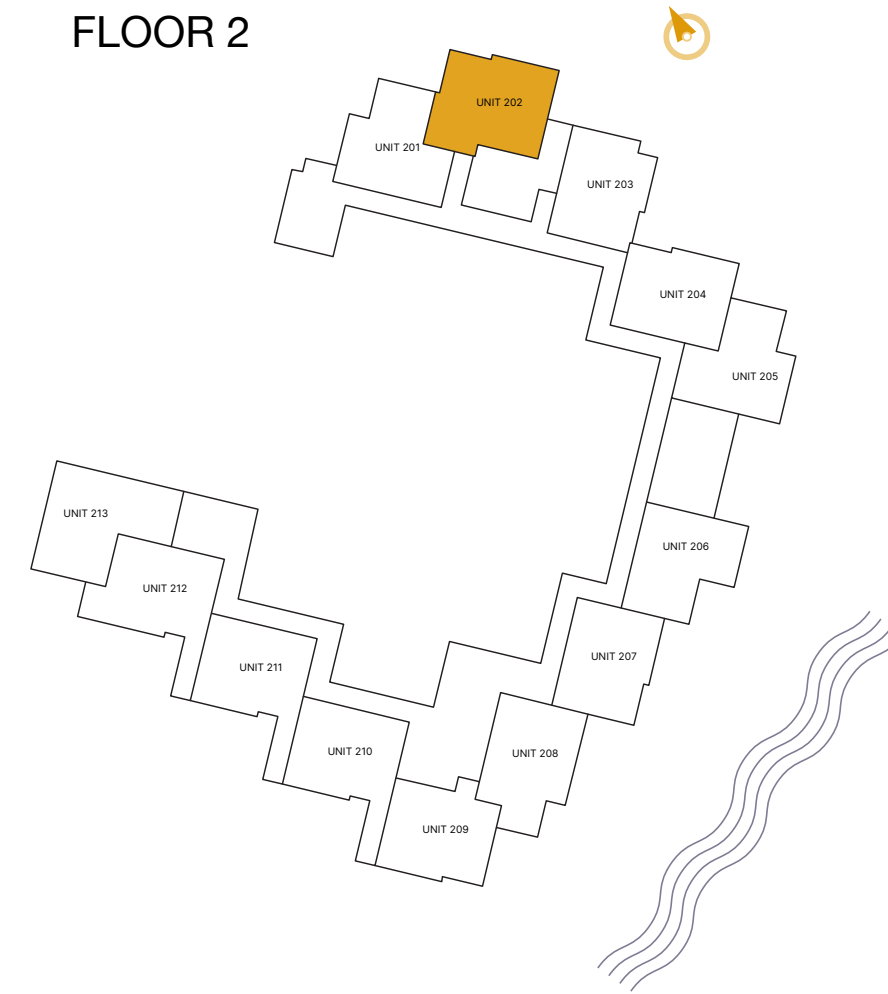

FLOOR 3

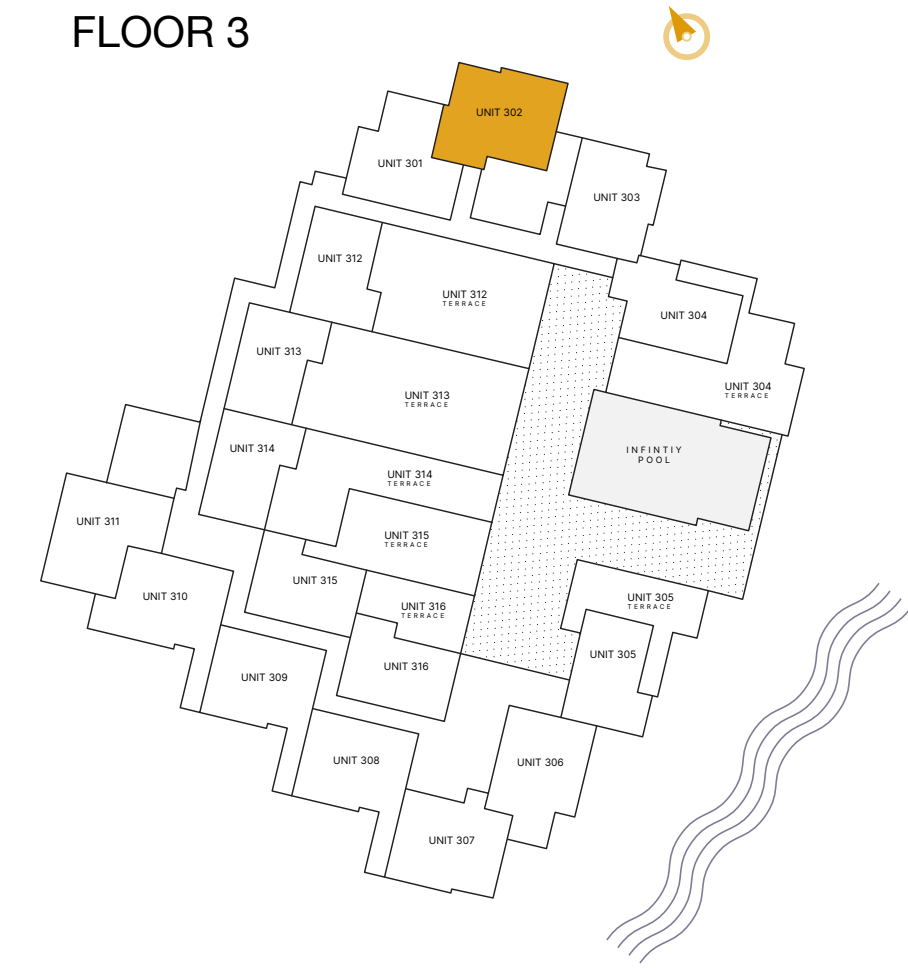

FLOOR 4

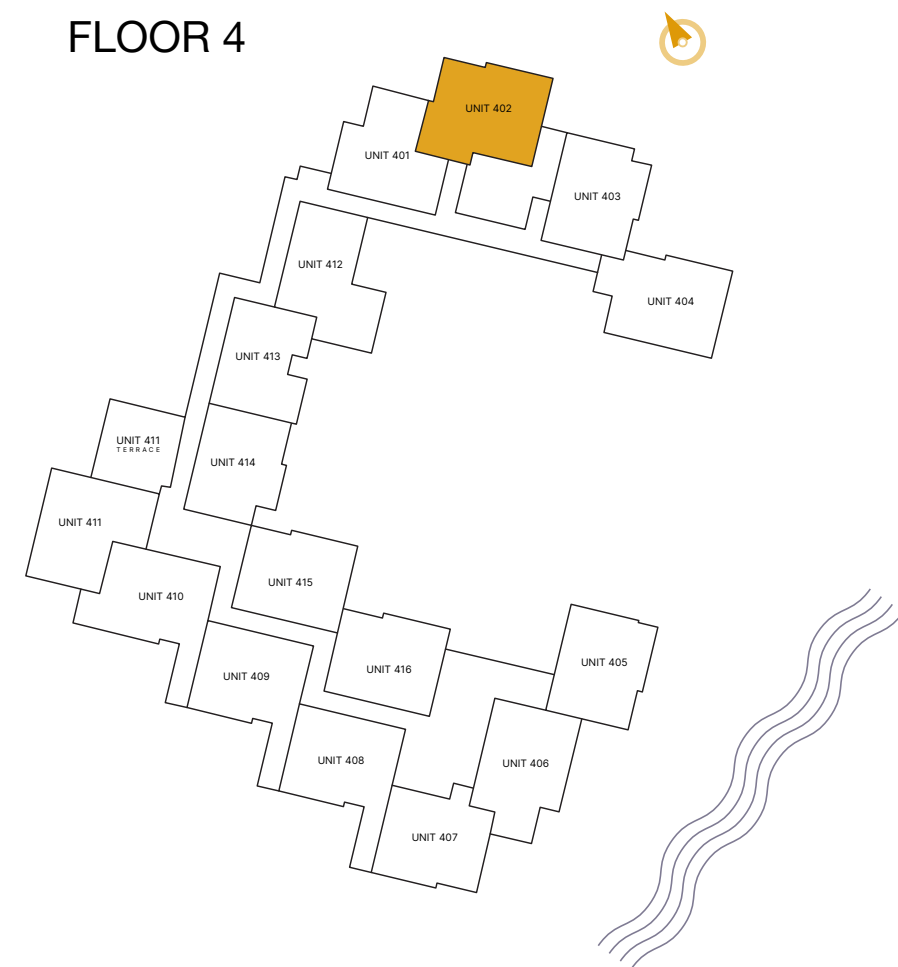

FLOOR 5

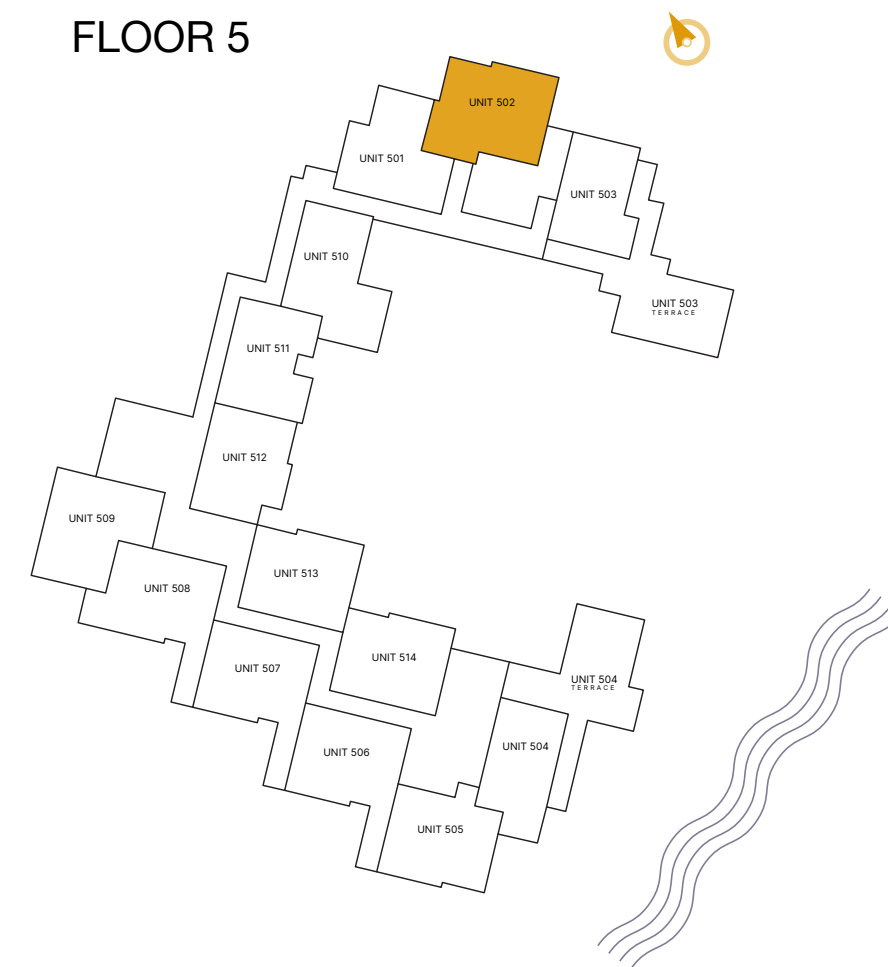

THE WEEKEND
FROM LES VAGUES BY ELIE SAAB

2-BED Type B4		FLOORS
		G, 1 - 5
RESIDENCE	80.15 - 81.37 sqm	862.73 - 875.86 sqft
BALCONY / TERRACE	9.2 -112.12 sqm	99.03 - 1206.85 sqft
TOTAL	89.35 - 193.09 sqm	961.76 - 2078.4 sqft

MASTERPLAN

The following floor plans are only applicable to Building D. All pictures, plans, layouts, information, data and details included in this brochure are indicative only and may change at any time up to the final 'as built' status in accordance with final designs of the project, regulatory approvals and planning permissions. All accessories and interior finishes such as wallpaper, chandeliers, furniture, electronics, white goods, curtains, hard and soft landscaping, pavements, features, gym, swimming pool(s) and other elements displayed in the brochure, or within the show apartment or between the plot boundary and the unit, are not part of the unit and are shown for illustrative purposes only.



THE WEEKEND
FROM LES VAGUES BY ELIE SAAB

BUILDING D - KEY PLANS
2-BED Type B4
FLOORS
G, 1 - 5

FLOOR G



FLOOR 1

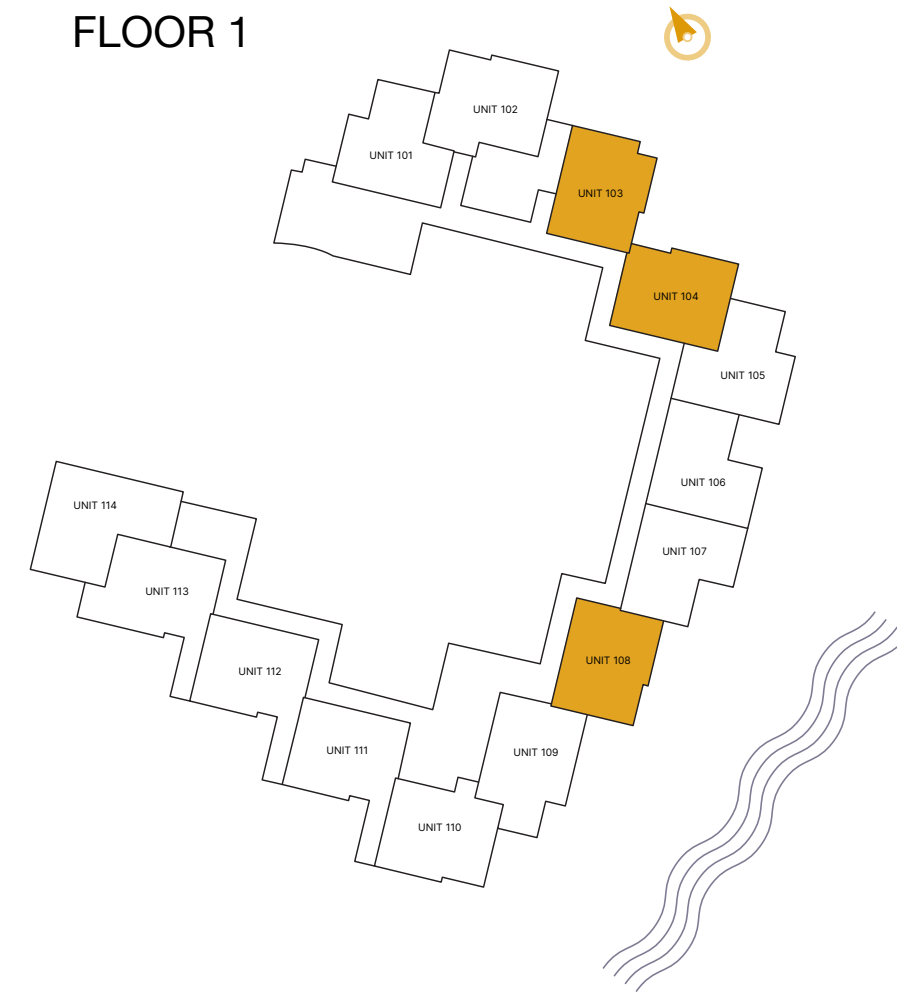

FLOOR 2

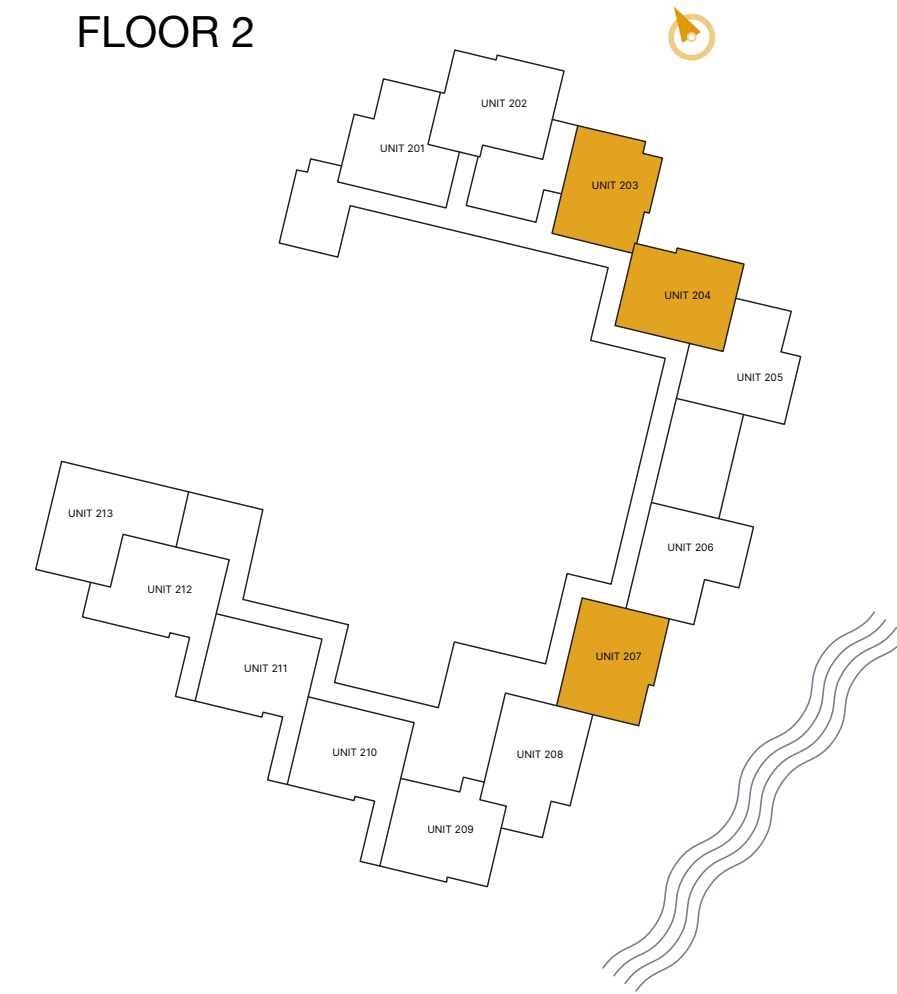

FLOOR 3

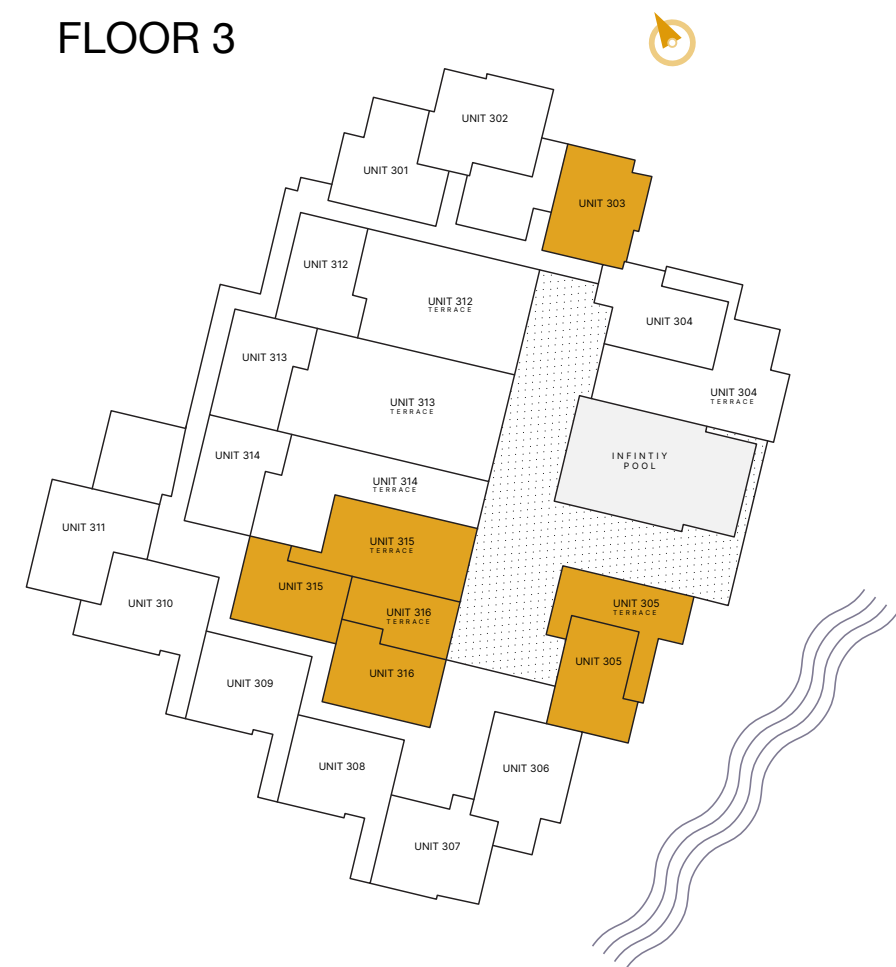

FLOOR 4

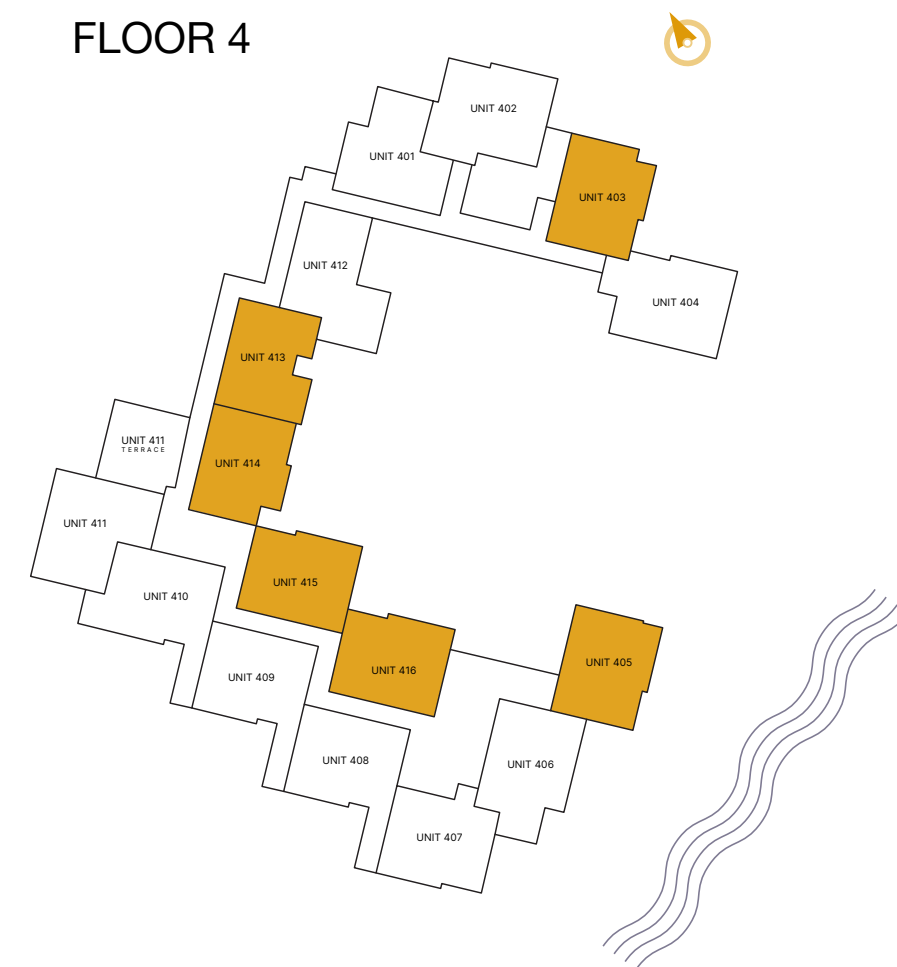

FLOOR 5

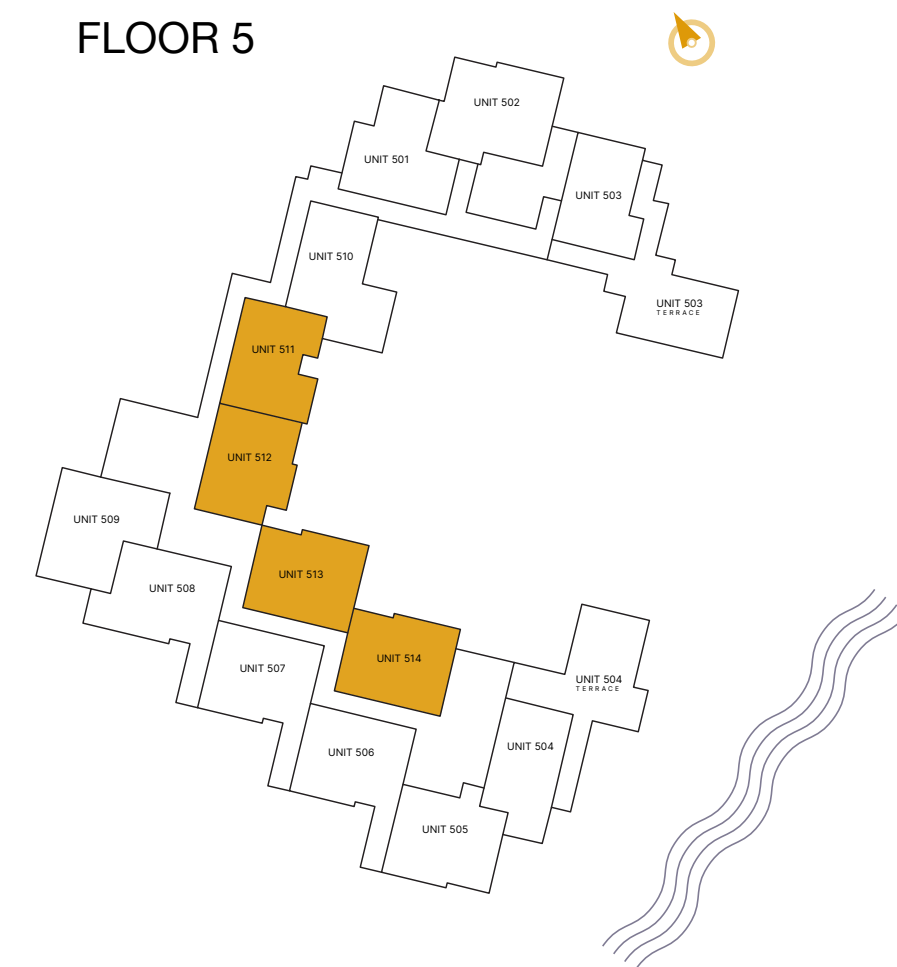

THE WEEKEND
FROM LES VAGUES BY ELIE SAAB

2-BED Type C	FLOORS	
	1 - 5	
RESIDENCE	80.12 - 81.42 sqm	862.4 - 876.4 sqft
BALCONY / TERRACE	13.8 - 62.36 sqm	148.54 - 671.24 sqft
TOTAL	93.95 - 164.48 sqm	1011.27 - 1770.45 sqft

MASTERPLAN

The following floor plans are only applicable to Building D. All pictures, plans, layouts, information, data and details included in this brochure are indicative only and may change at any time up to the final 'as built' status in accordance with final designs of the project, regulatory approvals and planning permissions. All accessories and interior finishes such as wallpaper, chandeliers, furniture, electronics, white goods, curtains, hard and soft landscaping, pavements, features, gym, swimming pool(s) and other elements displayed in the brochure, or within the show apartment or between the plot boundary and the unit, are not part of the unit and are shown for illustrative purposes only.



THE WEEKEND

FROM LES VAGUES BY ELIE SAAB

BUILDING D - KEY PLANS
2-BED Type C
FLOORS 1 - 5

FLOOR 1

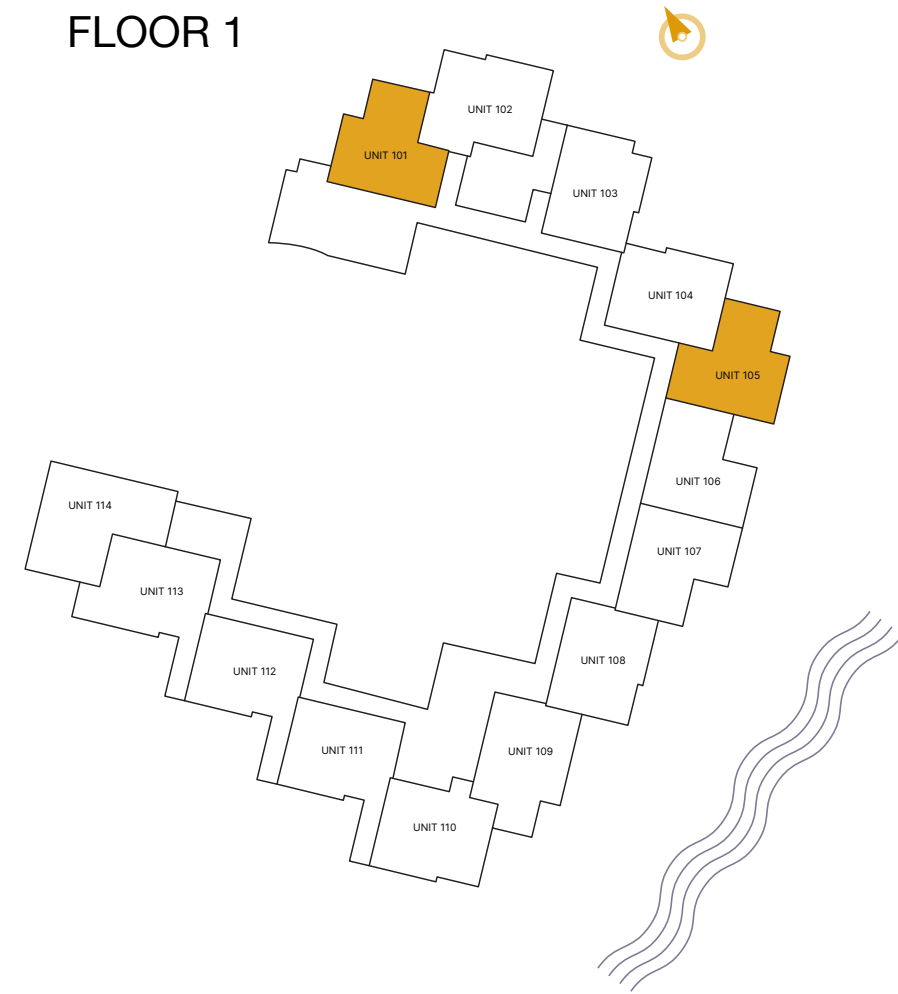

FLOOR 2

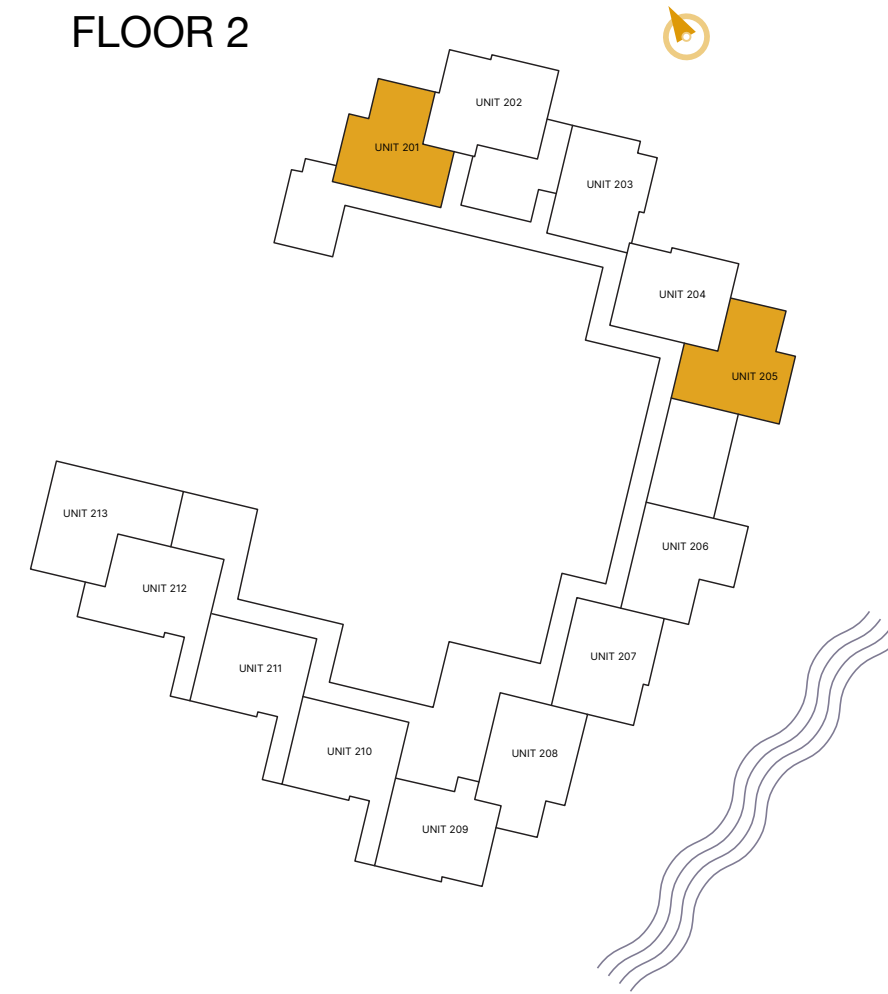

FLOOR 3



FLOOR 4

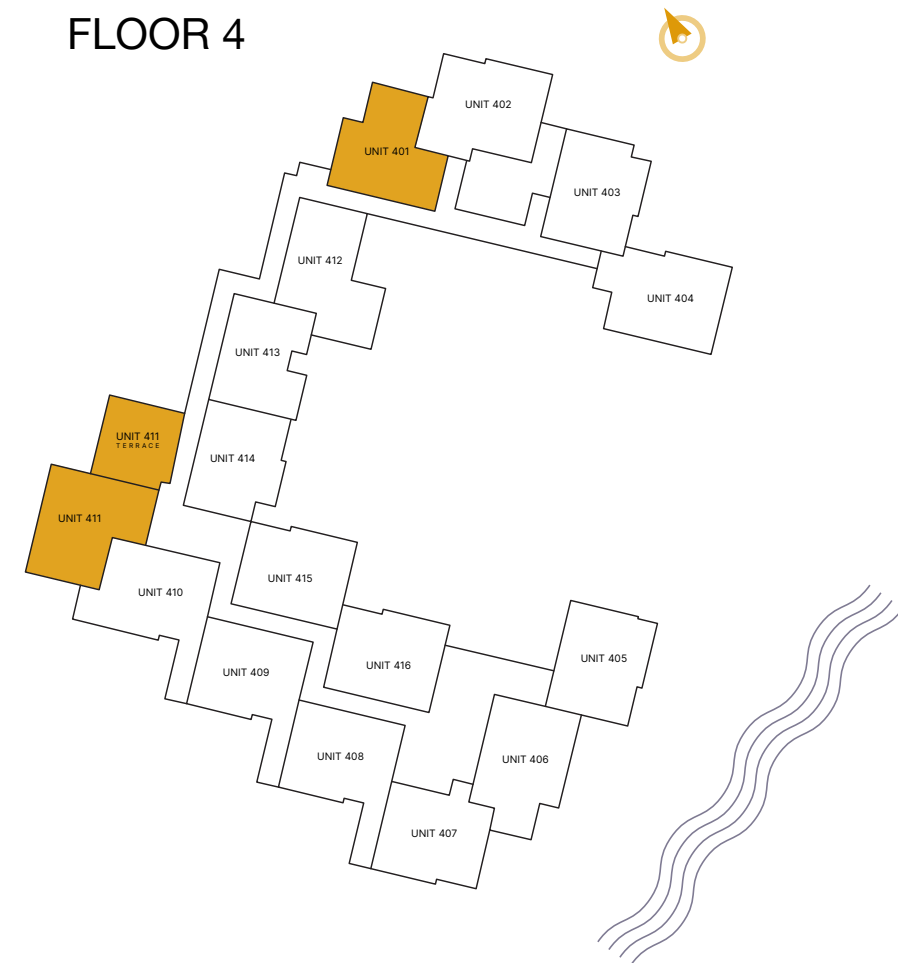

FLOOR 5



THE WEEKEND
FROM LES VAGUES BY ELIE SAAB

2-BED Type C1		FLOORS
		G
RESIDENCE	88.32 sqm	950.67 sqft
BALCONY / TERRACE	77.84 sqm	837.86 sqft
TOTAL	166.16 sqm	1788.53 sqft

MASTERPLAN

The following floor plans are only applicable to Building D. All pictures, plans, layouts, information, data and details included in this brochure are indicative only and may change at any time up to the final 'as built' status in accordance with final designs of the project, regulatory approvals and planning permissions. All accessories and interior finishes such as wallpaper, chandeliers, furniture, electronics, white goods, curtains, hard and soft landscaping, pavements, features, gym, swimming pool(s) and other elements displayed in the brochure, or within the show apartment or between the plot boundary and the unit, are not part of the unit and are shown for illustrative purposes only.



THE WEEKEND
FROM LES VAGUES BY ELIE SAAB

BUILDING D - KEY PLANS
2-BED Type C1
FLOORS
G

FLOOR G

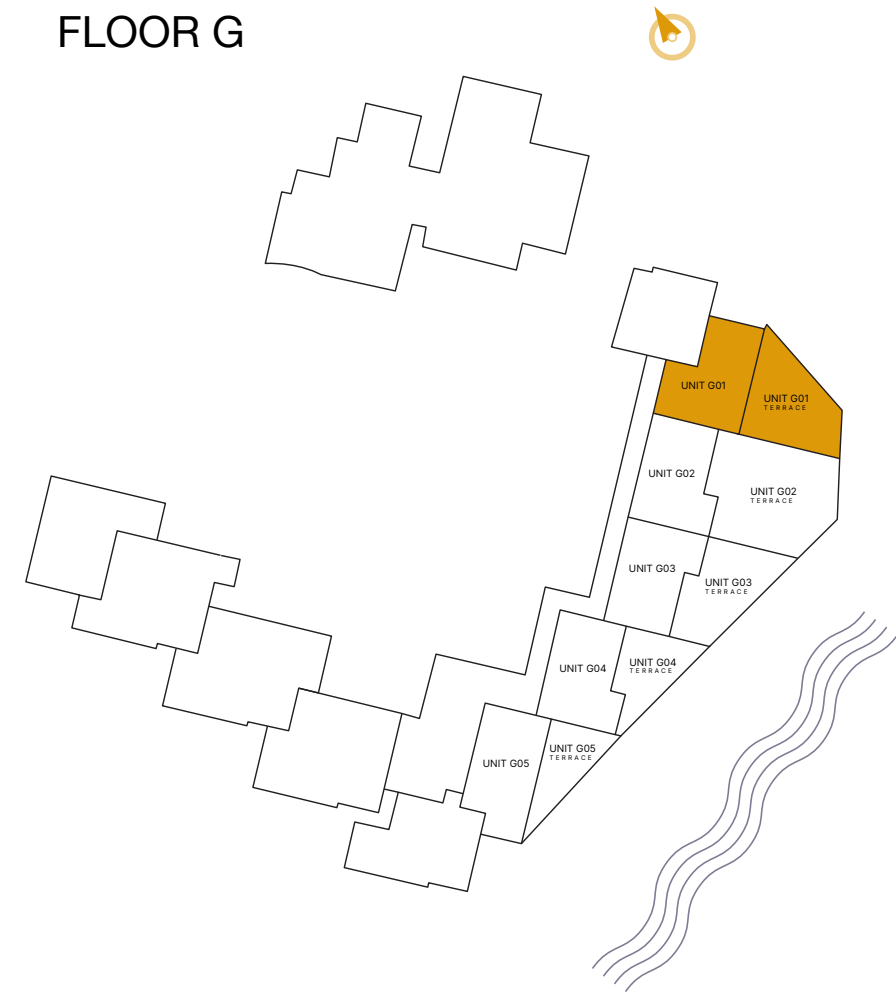

THE WEEKEND
FROM LES VAGUES BY ELIE SAAB

2-BED Type C2		FLOORS
		1 - 2
RESIDENCE	91.93 - 91.97 sqm	989.53 - 989.96 sqft
BALCONY / TERRACE	22 sqm	236.81 sqft
TOTAL	113.93 - 113.97 sqm	1226.33 - 1226.76 sqft

MASTERPLAN

The following floor plans are only applicable to Building D. All pictures, plans, layouts, information, data and details included in this brochure are indicative only and may change at any time up to the final 'as built' status in accordance with final designs of the project, regulatory approvals and planning permissions. All accessories and interior finishes such as wallpaper, chandeliers, furniture, electronics, white goods, curtains, hard and soft landscaping, pavements, features, gym, swimming pool(s) and other elements displayed in the brochure, or within the show apartment or between the plot boundary and the unit, are not part of the unit and are shown for illustrative purposes only.



THE WEEKEND
FROM LES VAGUES BY ELIE SAAB

BUILDING D - KEY PLANS
2-BED Type C1
FLOORS
1 - 2

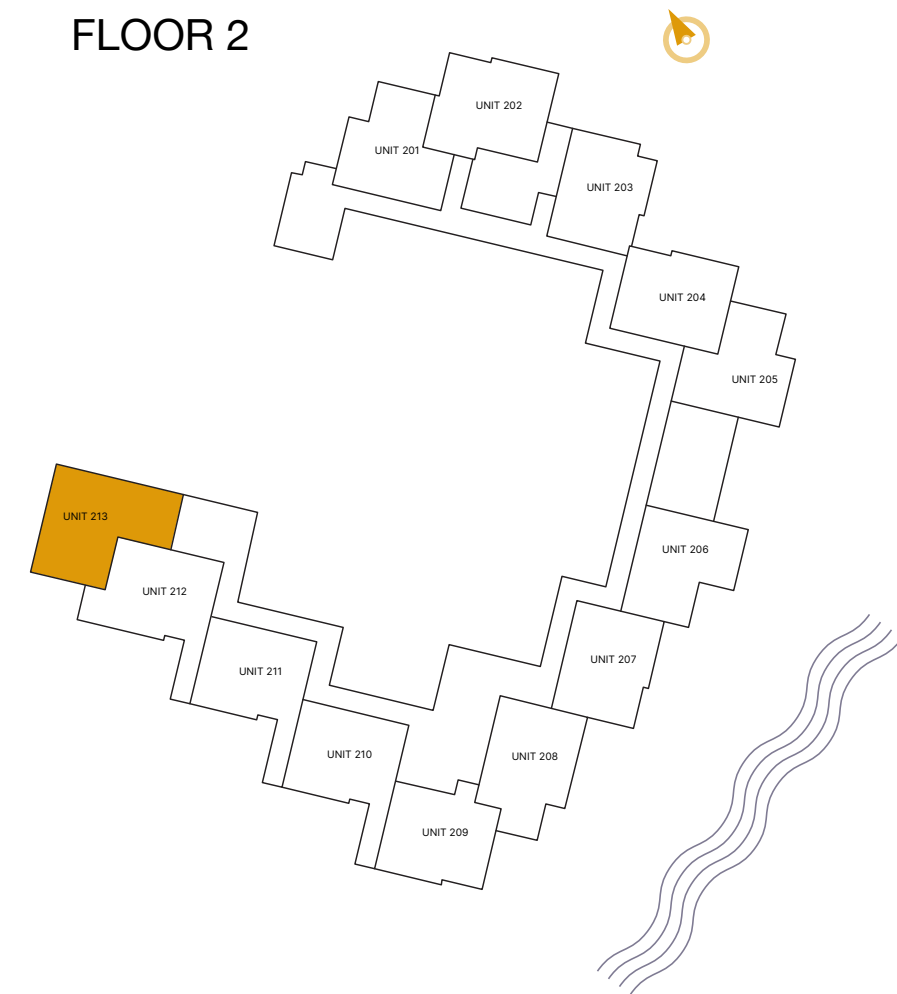
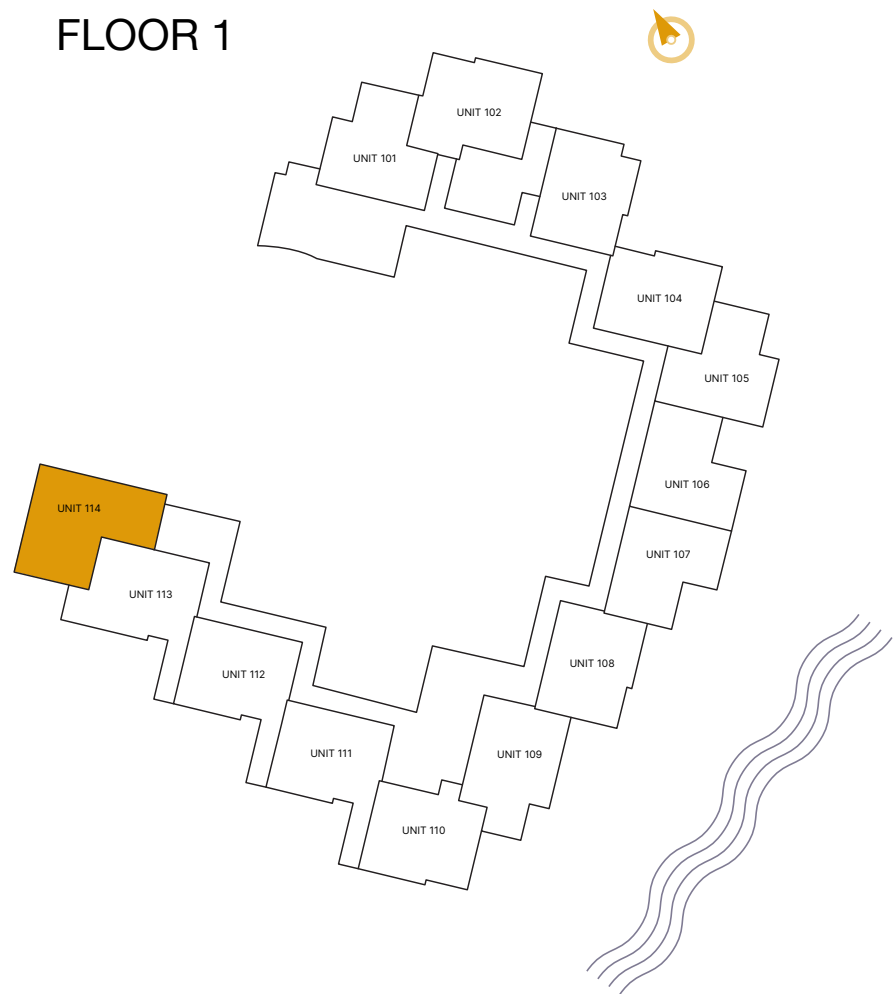

DAR GLOBAL PLC

DARGLOBAL

LISTED ON THE LONDON STOCK EXCHANGE

Established in 2017 to upend the global luxury real estate market, DarGlobal combines experience and innovation to deliver the highest quality properties. World-class architects curate DarGlobal's homes that are modelled by renowned design icons; each DarGlobal home is built with the highest quality materials and maintained by experts within the field.

DarGlobal believes there is no better investment than an investment in luxury and takes pride in choosing the best-in-class locations and properties to provide lucrative investment opportunities for a distinct clientele.

BUILDING ON THE LEGACY
OF THE LARGEST REAL ESTATE
COMPANY IN THE REGION.

—
7
offices in different
cities worldwide

—
15.000+
residential units
delivered

—
500.000 sqm
of commercial space

—
30
years of
experience

—
8.6 Bn*
USD in assets

* Combined assets of DarGlobal and Dar Al Arkan as of 31 March, 2023.



OUR OFFICES

DARGLOBAL

**DOHA
QATAR**

Malibu Building,
Lusail Entertainment City,
Doha, Qatar
T +974 800 3536

**DUBAI
UAE**

Jumeirah Emirates Towers
30th Floor, Sheikh Zayed Road
PO Box 2523, Dubai,
United Arab Emirates
T +971 4 247 8999

**LONDON
UK**

50 Hans Crescent,
Knightsbridge, London,
SW1X 0NA, United Kingdom
T +44 7875 495156

**MARBELLA
SPAIN**

Marbella Club Golden Mile,
Av. Bulevar Príncipe Alfonso de
Hohenlohe, Marbella 29602,
Málaga, Spain
T +34 952 68 76 80

**MUSCAT
OMAN**

Royal Opera House Muscat
Shatti Al Qurum, Muscat,
Sultanate of Oman
T +968 2270 2777

For more information on
The Weekend from Les Vagues
by ELIE SAAB, please call
+974 800 3536 (Qatar)

You can also check our website
darglobal.co.uk

or our social media platforms



DARGLOBAL

DARGLOBAL.CO.UK